

MACHINED HIGH TECHNOLOGY PLASTIC THUMB SCREWS

*See previous page for available materials.

Part No. Q104 - (Size Code No.) - (Material Code No.)
(below) (page 149)

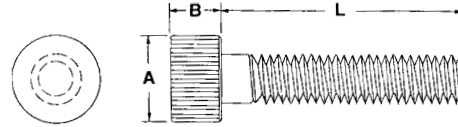

Size Code No.	Thread Size	Length	Size Code No.	Thread Size	Length	Size Code No.	Thread Size	Length	Size Code No.	Thread Size	Length	Size Code No.	Thread Size	Length
-1	2-56	1/4	-59	6-32	7/8	-117	1/4-20	3/8	-175	5/16-24	2	-233	1/2-13	1-1/4
-2		5/16	-60		1	-118		7/16	-176		2-1/4	-234		1-1/2
-3		3/8	-61		1-1/8	-119		1/2	-177		2-1/2	-235		1-3/4
-4		7/16	-62		1-1/4	-120		9/16	-178		3	-236		2
-5		1/2	-63		1-1/2	-121		5/8	-179	3/8-16	1/2	-237		2-1/2
-6		9/16	-64	6-40	1/4	-122		3/4	-180		9/16	-238		3
-7		5/8	-65		5/16	-123		7/8	-181		5/8	-239	1/2-20	3/4
-8		3/4	-66		3/8	-124		1	-182		3/4	-240		1
-9		7/8	-67		7/16	-125		1-1/8	-183		7/8	-241		1-1/4
-10		1	-68		1/2	-126		1-1/4	-184		1	-242		1-1/2
-11	3-48	1/4	-69		9/16	-127		1-1/2	-185		1-1/8	-243		1-3/4
-12		5/16	-70		5/8	-128		1-3/4	-186		1-1/4	-244		2
-13		3/8	-71		3/4	-129		2	-187		1-1/2	-245		2-1/2
-14		7/16	-72		7/8	-130		2-1/4	-188		1-3/4	-246		3
-15		1/2	-73		1	-131		2-1/2	-189		2	-247	9/16-18	3/4
-16		9/16	-74		1-1/8	-132	1/4-28	3/8	-190		2-1/4	-248		1
-17		5/8	-75		1-1/4	-133		7/16	-191		2-1/2	-249		1-1/4
-18		3/4	-76		1-1/2	-134		1/2	-192		3	-250		1-1/2
-19		7/8	-77	8-32	1/4	-135		9/16	-193	3/8-24	1/2	-251		1-3/4
-20		1	-78		5/16	-136		5/8	-194		9/16	-252		2
-21	4-40	1/4	-79		3/8	-137		3/4	-195		5/8	-253		2-1/2
-22		5/16	-80		7/16	-138		7/8	-196		3/4	-254		3
-23		3/8	-81		1/2	-139		1	-197		7/8	-255	9/16-20	3/4
-24		7/16	-82		9/16	-140		1-1/8	-198		1	-256		1
-25		1/2	-83		5/8	-141		1-1/4	-199		1-1/8	-257		1-1/4
-26		9/16	-84		3/4	-142		1-1/2	-200		1-1/4	-258		1-1/2
-27		5/8	-85		7/8	-143		1-3/4	-201		1-1/2	-259		1-3/4
-28		3/4	-86		1	-144		2	-202		1-3/4	-260		2
-29		7/8	-87		1-1/8	-145		2-1/4	-203		2	-261		2-1/2
-30		1	-88		1-1/4	-146		2-1/2	-204		2-1/4	-262		3
-31	4-48	1/4	-89		1-1/2	-147		3	-205		2-1/2	-263	5/8-11	1
-32		5/16	-90	10-24	1/4	-148	5/16-18	3/8	-206		3	-264		1-1/4
-33		3/8	-91		5/16	-149		7/16	-207	7/16-14	1/2	-265		1-1/2
-34		7/16	-92		3/8	-150		1/2	-208		5/8	-266		1-3/4
-35		1/2	-93		7/16	-151		9/16	-209		3/4	-267		2
-36		9/16	-94		1/2	-152		5/8	-210		1	-268		2-1/2
-37		5/8	-95		9/16	-153		3/4	-211		1-1/8	-269		3
-38		3/4	-96		5/8	-154		7/8	-212		1-1/4	-270	5/8-18	1
-39		7/8	-97		3/4	-155		1	-213		1-1/2	-271		1-1/4
-40		1	-98		7/8	-156		1-1/8	-214		1-3/4	-272		1-1/2
-41	5-40	1/4	-99		1	-157		1-1/4	-215		2	-273		1-3/4
-42		5/16	-100		1-1/8	-158		1-1/2	-216		2-1/4	-274		2
-43		3/8	-101		1-1/4	-159		1-3/4	-217		2-1/2	-275		2-1/2
-44		7/16	-102		1-1/2	-160		2	-218		3	-276		3
-45		1/2	-103	10-32	1/4	-161		2-1/2	-219	7/16-20	1/2	-277	3/4-10	1
-46		9/16	-104		5/16	-162		3	-220		5/8	-278		1-1/4
-47		5/8	-105		3/8	-163	5/16-24	3/8	-221		3/4	-279		1-1/2
-48		3/4	-106		7/16	-164		7/16	-222		1	-280		1-3/4
-49		7/8	-107		1/2	-165		1/2	-223		1-1/8	-281		2
-50		1	-108		9/16	-166		9/16	-224		1-1/4	-282		2-1/2
-51	6-32	1/4	-109		5/8	-167		5/8	-225		1-1/2	-283		3
-52		5/16	-110		3/4	-168		3/4	-226		1-3/4	-284	3/4-16	1
-53		3/8	-111		7/8	-169		7/8	-227		2	-285		1-1/4
-54		7/16	-112		1	-170		1	-228		2-1/4	-286		1-1/2
-55		1/2	-113		1-1/8	-171		1-1/8	-229		2-1/2	-287		1-3/4
-56		9/16	-114		1-1/4	-172		1-1/4	-230		3	-288		2
-57		5/8	-115		1-1/2	-173		1-1/2	-231	1/2-13	3/4	-289		2-1/2
-58		3/4	-116		2	-174		1-3/4	-232		1	-290		3

Thread Size	A	B	Thread Size	A	B	Thread Size	A	B	Thread Size	A	B	Thread Size	A	B
2-56	.250	.250	6-32	.375	.312	1/4-20	.500	.375	3/8-24	.625	.375	9/16-18	.750	.437
3-48	.250	.250	6-40	.375	.312	1/4-28	.500	.375	7/16-14	.625	.375	9/16-20	.750	.437
4-40	.312	.250	8-32	.431	.312	5/16-18	.562	.375	7/16-20	.625	.375	5/8-11	.875	.437
4-48	.312	.312	10-24	.437	.312	5/16-24	.562	.375	1/2-13	.750	.437	3/4-10	1.000	.500
5-40	.312	.312	10-32	.437	.312	3/8-16	.625	.375	1/2-20	.750	.437	3/4-16	1.000	.500

MACHINED HIGH TECHNOLOGY PLASTIC THUMB SCREWS (continued)

KNURLED THUMB SCREWS

Part No. DF226 - (Size Code No.) - (Material Code No.)
(below) (page 149)

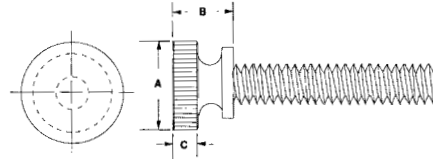

Thread Size	A	B	C	Thread Size	A	B	C
4-40	.300	.280	.120	1/4-28	.540	.365	.155
6-32	.360	.275	.125	5/16-18	.625	.406	.171
8-32	.425	.305	.140	3/8-16	.687	.437	.187
10-24	.425	.325	.140	1/2-13	.750	.468	.203
10-32	.425	.325	.140	1/2-20	.750	.468	.203
1/4-20	.540	.365	.155				

SLOTTED THUMB SCREWS

Part No. D227 - (Size Code No.) - (Material Code No.)
(below) (page 149)

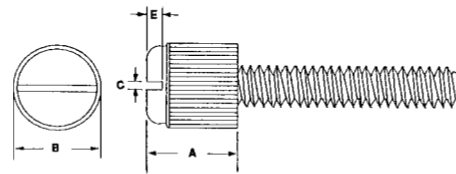

Thread Size	A	B	C	E	Thread Size	A	B	C	E
4-40	.216	.317	.039	.045	1/4-28	.326	.492	.070	.088
6-32	.250	.348	.042	.051	5/16-18	.348	.562	.078	.095
8-32	.280	.381	.049	.059	3/8-16	.382	.625	.087	.112
10-24	.317	.412	.056	.068	1/2-13	.500	.750	.098	.146
10-32	.317	.412	.056	.068	1/2-20	.500	.750	.098	.146
1/4-20	.326	.492	.070	.088					

KNURLED AND SLOTTED THUMB SCREWS SIZE CODE CHART

Size Code No.	Thread Size	Length	Size Code No.	Thread Size	Length	Size Code No.	Thread Size	Length	Size Code No.	Thread Size	Length	Size Code No.	Thread Size	Length
-1	4-40	1/4	-19	6-32	7/8	-37	10-24	5/8	-55	10-32	1 1/2	-73	5/16-18	1 1/2
-2	4-40	5/16	-20	6-32	1	-38	10-24	3/4	-56	10-32	2	-74	5/16-18	2
-3	4-40	3/8	-21	8-32	1/4	-39	10-24	7/8	-57	1/4-20	1/2	-75	3/8-16	1/2
-4	4-40	7/16	-22	8-32	5/16	-40	10-24	1	-58	1/4-20	3/4	-76	3/8-16	3/4
-5	4-40	1/2	-23	8-32	3/8	-41	10-24	1 1/4	-59	1/4-20	1	-77	3/8-16	1
-6	4-40	9/16	-24	8-32	7/16	-42	10-24	1 1/2	-60	1/4-20	1 1/4	-78	3/8-16	1 1/4
-7	4-40	5/8	-25	8-32	1/2	-43	10-24	2	-61	1/4-20	1 1/2	-79	3/8-16	1 1/2
-8	4-40	3/4	-26	8-32	9/16	-44	10-32	1/4	-62	1/4-20	2	-80	3/8-16	2
-9	4-40	7/8	-27	8-32	5/8	-45	10-32	5/16	-63	1/4-28	1/2	-81	1/2-13	1/2
-10	4-40	1	-28	8-32	3/4	-46	10-32	3/8	-64	1/4-28	3/4	-82	1/2-13	1
-11	6-32	1/4	-29	8-32	7/8	-47	10-32	7/16	-65	1/4-28	1	-83	1/2-13	1 1/2
-12	6-32	5/16	-30	8-32	1	-48	10-32	1/2	-66	1/4-28	1 1/4	-84	1/2-13	2
-13	6-32	3/8	-31	10-24	1/4	-49	10-32	9/16	-67	1/4-28	1 1/2	-85	1/2-13	2 1/2
-14	6-32	7/16	-32	10-24	5/16	-50	10-32	5/8	-68	1/4-28	2	-86	1/2-20	1/2
-15	6-32	1/2	-33	10-24	3/8	-51	10-32	3/4	-69	5/16-18	1/2	-87	1/2-20	1
-16	6-32	9/16	-34	10-24	7/16	-52	10-32	7/8	-70	5/16-18	3/4	-88	1/2-20	1 1/2
-17	6-32	5/8	-35	10-24	1/2	-53	10-32	1	-71	5/16-18	1	-89	1/2-20	2
-18	6-32	3/4	-36	10-24	9/16	-54	10-32	1 1/4	-72	5/16-18	1 1/4	-90	1/2-20	2 1/2

MACHINED HIGH TECHNOLOGY PLASTIC HEADLESS SET SCREWS: COMBINATION SLOT AND SOCKET

*Available in other materials. See material list in index.
Other sizes available on request.

*Available in the following materials:

Material Code No.	Material Name	Material Code No.	Material Name	Material Code No.	Material Name	Material Code No.	Material Name
-3	Lexan®, (clear)	-27	PVC	-40	PFA, (Teflon®)	-195	Nylon 46, 30% Glass-filled, Flame Retardant, Heat Stabilized
-4	Lexan®, (black)	-28	CPVC	-41	Halar®	-213	Vespel®
-5	Ultem® 1000	-29	Teflon®	-60	Nylon 6/6, 30% Short Glass-filled	-272	PVC, (white)
-11	Polypropylene	-30	Tefzel®	-64	Delrin®, 25% Short Glass-filled	-273	PVC, (black)
-13	Polyethylene	-32	PCTFE	-77	Ultem® 2300, (natural)	-226	Radel® A200, Polyethersulfone
-14	ABS	-33	Polysulfone	-78	Nylon 6/6, (black)	-228	Radel® AG330, 30% Glass-filled
-15	PEEK™	-35	Noryl®	-194	Nylon 46, 30% Glass-filled, Heat Stabilized	-229	Radel® R5000, Polyphenylsulfone
-18	Nylon 6/6, (natural)	-37	PVDF				
-23	Nylon Super Tough	-38	Fiber Glass G10				
-24	Delrin®, (white)	-39	UHMW®				

PLAIN POINT

Part No. **HN103** - (Size Code No.) - (Material Code No.)
(below) (above)

(Note: 0-80 and 1-72 size are slotted only.)

Size Code No.	Thread Size	Length	Size Code No.	Thread Size	Length	Size Code No.	Thread Size	Length
-1	0-80	1/8	-25	6-32	3/16	-49	10-24	5/8
-2	1-72	1/8	-26	6-32	1/4	-50	10-24	25/32
-3	1-72	9/32	-27	6-32	5/16	-51	10-32	1/8
-4	2-56	3/16	-28	6-32	3/8	-52	10-32	1/4
-5	2-56	7/32	-29	6-32	7/16	-53	10-32	5/16
-6	2-56	1/4	-30	6-32	1/2	-54	10-32	3/8
-7	2-56	9/32	-31	6-32	5/8	-55	10-32	7/16
-8	2-56	3/8	-32	6-32	3/4	-56	10-32	1/2
-9	2-56	13/32	-33	6-32	7/8	-57	10-32	5/8
-10	2-56	1/2	-34	6-32	1	-58	10-32	3/4
-11	3-48	5/32	-35	8-32	1/4	-59	10-32	1
-12	3-48	1/4	-36	8-32	9/32	-60	1/4-20	1/4
-13	4-40	1/8	-37	8-32	5/16	-61	1/4-20	3/8
-14	4-40	3/16	-38	8-32	3/8	-62	1/4-20	7/16
-15	4-40	1/4	-39	8-32	7/16	-63	1/4-20	1/2
-16	4-40	5/16	-40	8-32	1/2	-64	1/4-20	5/8
-17	4-40	3/8	-41	8-32	5/8	-65	1/4-20	3/4
-18	4-40	1/2	-42	8-32	3/4	-66	1/4-20	13/16
-19	4-40	9/16	-43	8-32	7/8	-67	1/4-20	1
-20	4-40	5/8	-44	8-32	1	-68	1/4-28	1
-21	4-40	3/4	-45	10-24	3/16	-69	1/4-28	1 1/32
-22	4-40	7/8	-46	10-24	5/16	-70	5/16-18	1/2
-23	4-40	1	-47	10-24	11/32	-71	3/8-16	1/2

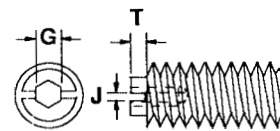

Thread Size	J	G	T
0-80	.014	--	.018
1-72	.016	--	.020
2-56	.016	.027	.027
3-48	.018	.035	.027
4-40	.020	.035	.031
6-32	.025	.050	.035
8-32	.029	.063	.041
10-24	.032	.078	.048
10-32	.032	.078	.048
1/4-20	.045	.094	.063
5/16-18	.051	.126	.078
3/8-16	.064	.157	.094

MACHINED HIGH TECHNOLOGY PLASTIC HEADLESS SET SCREWS: Combination Slot and Socket (continued)

FLAT POINT

Part No. HN104 - (Size Code No.) - (Material Code No.)
 (below) (page 152)

Size Code No.	Thread Size	Length	Size Code No.	Thread Size	Length	Size Code No.	Thread Size	Length
-1	4-40	1/8	-11	4-40	1	-21	10-32	1/8
-2	4-40	3/16	-12	8-32	1/4	-22	10-32	1/4
-3	4-40	1/4	-13	8-32	5/16	-23	10-32	5/16
-4	4-40	5/16	-14	8-32	3/8	-24	10-32	3/8
-5	4-40	3/8	-15	8-32	7/16	-25	10-32	7/16
-6	4-40	1/2	-16	8-32	1/2	-26	10-32	1/2
-7	4-40	9/16	-17	8-32	5/8	-27	10-32	5/8
-8	4-40	5/8	-18	8-32	3/4	-28	10-32	3/4
-9	4-40	3/4	-19	8-32	7/8	-29	10-32	1
-10	4-40	7/8	-20	8-32	1			

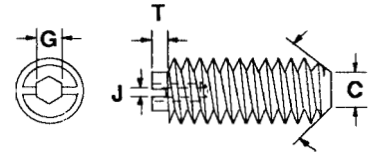

Thread Size	J	G	T	C
4-40	.020	.035	.031	.056
8-32	.029	.063	.041	5/64
10-32	.032	.078	.048	3/32

OVAL POINT

Part No. HN106 - (Size Code No.) - (Material Code No.)
 (below) (page 152)

Size Code No.	Thread Size	Length	Size Code No.	Thread Size	Length	Size Code No.	Thread Size	Length
-1	4-40	1/8	-18	6-32	1/2	-35	10-32	3/8
-2	4-40	3/16	-19	6-32	5/8	-36	10-32	7/16
-3	4-40	1/4	-20	6-32	3/4	-37	10-32	1/2
-4	4-40	5/16	-21	6-32	7/8	-38	10-32	5/8
-5	4-40	3/8	-22	6-32	1	-39	10-32	3/4
-6	4-40	1/2	-23	8-32	1/4	-40	10-32	1
-7	4-40	9/16	-24	8-32	5/16	-41	1/4-20	1/4
-8	4-40	5/8	-25	8-32	3/8	-42	1/4-20	3/8
-9	4-40	3/4	-26	8-32	7/16	-43	1/4-20	7/16
-10	4-40	7/8	-27	8-32	1/2	-44	1/4-20	1/2
-11	4-40	1	-28	8-32	5/8	-45	1/4-20	5/8
-12	6-32	1/8	-29	8-32	3/4	-46	1/4-20	3/4
-13	6-32	3/16	-30	8-32	7/8	-47	1/4-20	1
-14	6-32	1/4	-31	8-32	1	-48	1/4-28	1
-15	6-32	5/16	-32	10-32	1/8	-49	1/4-28	1 1/32
-16	6-32	3/8	-33	10-32	1/4	-50	5/16-24	3/8
-17	6-32	7/16	-34	10-32	5/16			

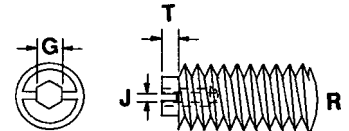

Thread Size	J	G	T	R
4-40	.020	.035	.031	.084
6-32	.025	.050	.035	7/64
8-32	.029	.063	.041	1/8
10-32	.032	.078	.048	9/64
1/4-20	.045	.094	.063	3/16
5/16-24	.051	.126	.094	--

CONE POINT

Part No. HN107 - (Size Code No.) - (Material Code No.)
 (below) (page 152)

Size Code No.	Thread Size	Length	Size Code No.	Thread Size	Length	Size Code No.	Thread Size	Length
-1	2-56	3/16	-9	6-32	3/8	-17	10-32	3/8
-2	2-56	7/32	-10	6-32	1/2	-18	10-32	7/16
-3	2-56	1/4	-11	6-32	5/8	-19	10-32	1/2
-4	2-56	3/8	-12	6-32	3/4	-20	10-32	5/8
-5	6-32	1/8	-13	6-32	1	-21	10-32	3/4
-6	6-32	3/16	-14	10-32	1/8	-22	10-32	1
-7	6-32	1/4	-15	10-32	1/4	-23	1/4-20	1/4
-8	6-32	5/16	-16	10-32	5/16			

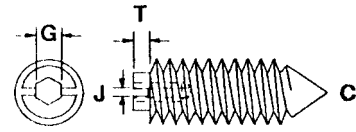

Thread Size	J	G	T	C
2-56	.016	.027	.027	.020
6-32	.025	.035	.031	.020
10-32	.032	.078	.048	.030
1/4-20	.045	.094	.063	.040

FULL DOG POINT

Part No. HN108 - (Size Code No.) - (Material Code No.)
 (below) (page 152)

Size Code No.	Thread Size	Length	Size Code No.	Thread Size	Length	Size Code No.	Thread Size	Length
-1	6-32	1/8	-8	6-32	5/8	-15	8-32	7/16
-2	6-32	3/16	-9	6-32	3/4	-16	8-32	1/2
-3	6-32	1/4	-10	6-32	7/8	-17	8-32	5/8
-4	6-32	5/16	-11	6-32	1	-18	8-32	3/4
-5	6-32	3/8	-12	8-32	1/4	-19	8-32	7/8
-6	6-32	7/16	-13	8-32	5/16	-20	8-32	1
-7	6-32	1/2	-14	8-32	3/8			

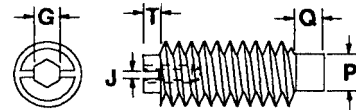

Thread Size	J	G	T	Q	P
6-32	.025	.050	.035	.070	.090
8-32	.029	.063	.041	.080	.106

HALF DOG POINT

Part No. HN109 - (Size Code No.) - (Material Code No.)
 (below) (page 152)

Size Code No.	Thread Size	Length	Size Code No.	Thread Size	Length	Size Code No.	Thread Size	Length
-1	2-56	.200	-8	6-32	1/2	-15	8-32	7/16
-2	6-32	1/8	-9	6-32	5/8	-16	8-32	1/2
-3	6-32	3/16	-10	6-32	3/4	-17	8-32	5/8
-4	6-32	1/4	-11	6-32	1	-18	8-32	3/4
-5	6-32	5/16	-12	8-32	1/4	-19	8-32	7/8
-6	6-32	3/8	-13	8-32	5/16	-20	8-32	1
-7	6-32	7/16	-14	8-32	3/8			

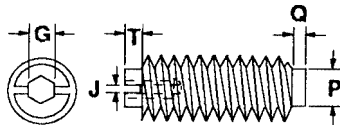

Thread Size	J	G	T	Q	P
2-56	.016	.027	.027	.022	.055
6-32	.025	.050	.035	.030	.090
8-32	.029	.063	.041	.040	.106

MACHINED HIGH TECHNOLOGY PLASTIC LARGE SIZE SET SCREWS

*Available in the following materials:

Material Code No.	Material Name	Material Code No.	Material Name	Material Code No.	Material Name	Material Code No.	Material Name
-3	Lexan®, (clear)	-23	Nylon Super Tough	-40	PFA, (Teflon®)	-195	Nylon 46, 30% Glass-filled, Flame Retardant, Heat Stabilized
-4	Lexan®, (black)	-24	Delrin®, (white)	-41	Halar®	-226	Radel® A200, Polyethersulfone
-5	Ultem® 1000	-25	Delrin® AF	-42	Nylatron® GS	-228	Radel® AG330, 30% Glass-filled
-7	PES®	-27	PVC	-43	Ertalyte®	-229	Radel® R5000, Polyphenylsulfone
-8	PES®, 30% Glass-filled	-28	CPVC	-44	Ertalon®	-213	Vespel®
-11	Polypropylene	-29	Teflon®	-58	Fiber Glass G11	-272	PVC, (white)
-12	Polystyrene	-30	Tefzel®	-77	Ultem® 2300, (natural)	-273	PVC, (black)
-13	Polyethylene	-31	FEP®	-194	Nylon 46, 30% Glass-filled, Heat Stabilized	-294	Teflon®, 20% Glass-filled
-14	ABS	-32	PCTFE				
-15	PEEK™	-33	Polysulfone				
-18	Nylon 6/6, (natural)	-35	Noryl®				
-19	Nylon 6/6, 20% Short Glass-filled	-36	Noryl®, Glass-filled				
-20	Nylon MDS	-37	PVDF				
-22	Nylon 612	-38	Fiber Glass G10				
		-39	UHMW®				

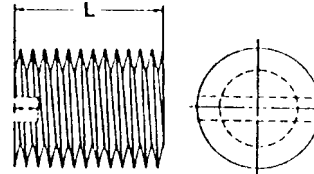

Part No. H102 - (Size Code No.) - (Material Code No.)

Size Code No.	Thread Size	Length	Size Code No.	Thread Size	Length	Size Code No.	Thread Size	Length	Size Code No.	Thread Size	Length
-1	1 1/8-7	3/4	-43	1 1/4-7	2 3/4	-85	1 3/8-8	2	-127	1 1/2-12	1 1/2
-2	1 1/8-7	1	-44	1 1/4-7	3	-86	1 3/8-8	2 1/2	-128	1 1/2-12	1 3/4
-3	1 1/8-7	1 1/8	-45	1 1/4-8	3/4	-87	1 3/8-8	2 3/4	-129	1 1/2-12	2
-4	1 1/8-7	1 1/4	-46	1 1/4-8	1	-88	1 3/8-8	3	-130	1 1/2-12	2 1/2
-5	1 1/8-7	1 3/8	-47	1 1/4-8	1 1/8	-89	1 3/8-12	3/4	-131	1 1/2-12	2 3/4
-6	1 1/8-7	1 1/2	-48	1 1/4-8	1 1/4	-90	1 3/8-12	1	-132	1 1/2-12	3
-7	1 1/8-7	1 3/4	-49	1 1/4-8	1 3/8	-91	1 3/8-12	1 1/8	-133	1 3/4-5	3/4
-8	1 1/8-7	2	-50	1 1/4-8	1 1/2	-92	1 3/8-12	1 1/4	-134	1 3/4-5	1
-9	1 1/8-7	2 1/2	-51	1 1/4-8	1 3/4	-93	1 3/8-12	1 3/8	-135	1 3/4-5	1 1/8
-10	1 1/8-7	2 3/4	-52	1 1/4-8	2	-94	1 3/8-12	1 1/2	-136	1 3/4-5	1 1/4
-11	1 1/8-7	3	-53	1 1/4-8	2 1/2	-95	1 3/8-12	1 3/4	-137	1 3/4-5	1 3/8
-12	1 1/8-8	3/4	-54	1 1/4-8	2 3/4	-96	1 3/8-12	2	-138	1 3/4-5	1 1/2
-13	1 1/8-8	1	-55	1 1/4-8	3	-97	1 3/8-12	2 1/2	-139	1 3/4-5	1 3/4
-14	1 1/8-8	1 1/8	-56	1 1/4-12	3/4	-98	1 3/8-12	2 3/4	-140	1 3/4-5	2
-15	1 1/8-8	1 1/4	-57	1 1/4-12	1	-99	1 3/8-12	3	-141	1 3/4-5	2 1/2
-16	1 1/8-8	1 3/8	-58	1 1/4-12	1 1/8	-100	1 1/2-6	3/4	-142	1 3/4-5	2 3/4
-17	1 1/8-8	1 1/2	-59	1 1/4-12	1 1/4	-101	1 1/2-6	1	-143	1 3/4-5	3
-18	1 1/8-8	1 3/4	-60	1 1/4-12	1 3/8	-102	1 1/2-6	1 1/8	-144	1 3/4-8	3/4
-19	1 1/8-8	2	-61	1 1/4-12	1 1/2	-103	1 1/2-6	1 1/4	-145	1 3/4-8	1
-20	1 1/8-8	2 1/2	-62	1 1/4-12	1 3/4	-104	1 1/2-6	1 3/8	-146	1 3/4-8	1 1/8
-21	1 1/8-8	2 3/4	-63	1 1/4-12	2	-105	1 1/2-6	1 1/2	-147	1 3/4-8	1 1/4
-22	1 1/8-8	3	-64	1 1/4-12	2 1/2	-106	1 1/2-6	1 3/4	-148	1 3/4-8	1 3/8
-23	1 1/8-12	3/4	-65	1 1/4-12	2 3/4	-107	1 1/2-6	2	-149	1 3/4-8	1 1/2
-24	1 1/8-12	1	-66	1 1/4-12	3	-108	1 1/2-6	2 1/2	-150	1 3/4-8	1 3/4
-25	1 1/8-12	1 1/8	-67	1 3/8-6	3/4	-109	1 1/2-6	2 3/4	-151	1 3/4-8	2
-26	1 1/8-12	1 1/4	-68	1 3/8-6	1	-110	1 1/2-6	3	-152	1 3/4-8	2 1/2
-27	1 1/8-12	1 3/8	-69	1 3/8-6	1 1/8	-111	1 1/2-8	3/4	-153	1 3/4-8	2 3/4
-28	1 1/8-12	1 1/2	-70	1 3/8-6	1 1/4	-112	1 1/2-8	1	-154	1 3/4-8	3
-29	1 1/8-12	1 3/4	-71	1 3/8-6	1 3/8	-113	1 1/2-8	1 1/8	-155	2-4	1
-30	1 1/8-12	2	-72	1 3/8-6	1 1/2	-114	1 1/2-8	1 1/4	-156	2-4	1 1/4
-31	1 1/8-12	2 1/2	-73	1 3/8-6	1 3/4	-115	1 1/2-8	1 3/8	-157	2-4	1 1/2
-32	1 1/8-12	2 3/4	-74	1 3/8-6	2	-116	1 1/2-8	1 1/2	-158	2-4	1 3/4
-33	1 1/8-12	3	-75	1 3/8-6	2 1/2	-117	1 1/2-8	1 3/4	-159	2-4	2
-34	1 1/4-7	3/4	-76	1 3/8-6	2 3/4	-118	1 1/2-8	2	-160	2-4	2 1/2
-35	1 1/4-7	1	-77	1 3/8-6	3	-119	1 1/2-8	2 1/2	-161	2-4	3
-36	1 1/4-7	1 1/8	-78	1 3/8-8	3/4	-120	1 1/2-8	2 3/4	-162	2-8	1
-37	1 1/4-7	1 1/4	-79	1 3/8-8	1	-121	1 1/2-8	3	-163	2-8	1 1/4
-38	1 1/4-7	1 3/8	-80	1 3/8-8	1 1/8	-122	1 1/2-12	3/4	-164	2-8	1 1/2
-39	1 1/4-7	1 1/2	-81	1 3/8-8	1 1/4	-123	1 1/2-12	1	-165	2-8	1 3/4
-40	1 1/4-7	1 3/4	-82	1 3/8-8	1 3/8	-124	1 1/2-12	1 1/8	-166	2-8	2
-41	1 1/4-7	2	-83	1 3/8-8	1 1/2	-125	1 1/2-12	1 1/4	-167	2-8	2 1/2
-42	1 1/4-7	2 1/2	-84	1 3/8-8	1 3/4	-126	1 1/2-12	1 3/8	-168	2-8	3