

# MACHINED HIGH PERFORMANCE PLASTIC SPACERS

\*Available in the following materials:

<b>Material Code No.</b>	<b>Material Name</b>	<b>Material Code No.</b>	<b>Material Name</b>	<b>Material Code No.</b>	<b>Material Name</b>	<b>Material Code No.</b>	<b>Material Name</b>
-11	Polypropylene	-31	FEP	-46	Polycarbonate	-195	Nylon 46, 30% Glass-filled, Heat Stabilized, Flame Retardant
-15	PEEK™	-32	PCTFE	-62	Acetal		
-27	PVC	-37	PVDF	-60	Nylon 6/6, 30% Short Glass-filled		
-28	CPVC	-38	G-10 Fiber Glass	-194	Nylon 46, 30% Glass-filled, Heat Stabilized		
-29	Teflon®	-40	Teflon®, (PFA)				

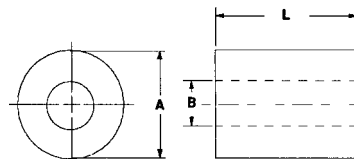

## ROUND SPACERS

Part No. DN208 - (Size Code No.) - (Material Code No.)

Size Code No.	O.D. A	I.D. B	Lgth. L	Size Code No.	O.D. A	I.D. B	Lgth. L	Size Code No.	O.D. A	I.D. B	Lgth. L
-1	.125	.030	.250	-47	.250	.100	.127	-94	.312	.115	.187
-2	.187	.042	.135	-48	.375	.105	.110	-95	.312	.115	.250
-3	.187	.042	.320	-49	.187	.115	.125	-96	.312	.115	.312
-4	.612	.060	.235	-50	.187	.115	.156	-97	.312	.115	.375
-5	.125	.063	.187	-51	.187	.115	.187	-98	.312	.115	.437
-6	.187	.067	.140	-52	.187	.115	.225	-99	.312	.115	.500
-7	.250	.075	.185	-53	.187	.115	.250	-100	.312	.115	.562
-8	.145	.078	.312	-54	.187	.115	.312	-101	.312	.115	.625
-9	.125	.090	.437	-56	.187	.115	.375	-102	.312	.115	.687
-10	.187	.091	.125	-57	.187	.115	.437	-103	.312	.115	.750
-11	.187	.091	.187	-58	.187	.115	.500	-104	.312	.115	.812
-12	.187	.091	.250	-59	.187	.115	.562	-105	.312	.115	.875
-13	.187	.091	.312	-60	.187	.115	.625	-106	.312	.115	.937
-14	.187	.091	.375	-61	.187	.115	.687	-107	.312	.115	1.000
-15	.187	.091	.437	-62	.187	.115	.750	-108	.312	.115	1.062
-16	.187	.091	.500	-63	.187	.115	.812	-109	.312	.115	1.125
-17	.187	.091	.562	-64	.187	.115	.875	-110	.312	.115	1.187
-18	.187	.091	.625	-65	.187	.115	.937	-111	.312	.115	1.250
-19	.187	.091	.687	-66	.187	.115	1.000	-112	.312	.115	1.312
-20	.187	.091	.750	-67	.225	.115	.145	-113	.312	.115	1.375
-21	.187	.091	.812	-68	.250	.115	.125	-114	.312	.115	1.437
-22	.187	.091	.844	-69	.250	.115	.187	-115	.312	.115	1.500
-23	.187	.091	.875	-70	.250	.115	.218	-116	.375	.115	.812
-24	.187	.091	.937	-71	.250	.115	.250	-117	.375	.115	1.062
-25	.187	.091	1.000	-72	.250	.115	.312	-118	.365	.120	.120
-26	.250	.091	.125	-73	.250	.115	.375	-119	.470	.120	.359
-27	.250	.091	.187	-74	.250	.115	.437	-120	.490	.120	.110
-28	.250	.091	.250	-75	.250	.115	.500	-121	.193	.125	.250
-29	.250	.091	.312	-76	.250	.115	.562	-122	.216	.125	.135
-30	.250	.091	.375	-77	.250	.115	.625	-123	.250	.125	.125
-31	.250	.091	.437	-78	.250	.115	.687	-124	.250	.125	.187
-32	.250	.091	.500	-79	.250	.115	.750	-125	.250	.125	.250
-33	.250	.091	.562	-80	.250	.115	.812	-126	.250	.125	.312
-34	.250	.091	.625	-81	.250	.115	.875	-127	.250	.125	.375
-35	.250	.091	.687	-82	.250	.115	.937	-128	.250	.125	.415
-36	.250	.091	.750	-83	.250	.115	1.000	-129	.250	.125	.437
-37	.250	.091	.812	-84	.250	.115	1.062	-130	.250	.125	.500
-38	.250	.091	.875	-85	.250	.115	1.125	-131	.250	.125	.625
-39	.250	.091	.937	-86	.250	.115	1.187	-132	.250	.125	.715
-40	.250	.091	1.000	-87	.250	.115	1.250	-133	.250	.125	.750
-41	.192	.093	.203	-88	.250	.115	1.312	-134	.250	.125	1.000
-42	.375	.094	.281	-89	.250	.115	1.375	-135	.280	.125	.297
-43	.145	.095	.390	-90	.250	.115	1.437	-136	.305	.125	.155
-44	.312	.095	.250	-91	.250	.115	1.500	-137	.312	.125	.125
-45	.160	.100	.406	-92	.251	.115	.531				
-46	.200	.100	.125	-93	.312	.115	.125				

(continued next page)

Tolerances on all dimensions +/- .010

**.030 I.D. to .125 I.D.**

MACHINED HIGH PERFORMANCE PLASTIC SPACERS (continued)

**ROUND SPACERS**

Part No. DN208 - (Size Code No.) - (Material Code No.)

\*Available in other materials.  
See materials list in index.  
Other sizes available on request.

Size Code No.	O.D. A	I.D. B	Lgth. L	Size Code No.	O.D. A	I.D. B	Lgth. L	Size Code No.	O.D. A	I.D. B	Lgth. L
-138	.312	.125	.187	-196	.312	.140	.312	-253	.500	.140	.937
-139	.312	.125	.250	-197	.312	.140	.375	-254	.500	.140	1.000
-140	.312	.125	.312	-198	.312	.140	.437	-255	.250	.141	.281
-141	.312	.125	.375	-199	.312	.140	.500	-256	.375	.141	.156
-142	.312	.125	.437	-200	.312	.140	.562	-257	.200	.145	.171
-143	.312	.125	.500	-201	.312	.140	.625	-258	.215	.145	.328
-144	.375	.125	.125	-202	.312	.140	.687	-259	.230	.147	.475
-145	.375	.125	.187	-203	.312	.140	.750	-260	.250	.147	.062
-146	.375	.125	.250	-204	.312	.140	.812	-261	.250	.147	.125
-147	.375	.125	.312	-205	.312	.140	.875	-262	.250	.147	.187
-148	.375	.125	.375	-206	.312	.140	1.000	-263	.250	.147	.215
-149	.375	.125	.437	-207	.312	.140	1.062	-264	.250	.147	.250
-150	.375	.125	.500	-208	.312	.140	1.125	-265	.250	.147	.297
-151	.437	.125	.125	-209	.312	.140	1.187	-266	.250	.147	.312
-152	.437	.125	.250	-210	.312	.140	1.250	-267	.250	.147	.375
-153	.437	.125	.312	-211	.312	.140	1.312	-268	.250	.147	.437
-154	.437	.125	.375	-212	.312	.140	1.375	-269	.250	.147	.500
-155	.437	.125	.437	-213	.312	.140	1.437	-270	.250	.147	.625
-156	.437	.125	.599	-214	.312	.140	1.500	-271	.250	.147	.750
-157	.250	.126	.797	-215	.375	.140	.125	-272	.250	.147	.875
-158	.310	.126	.410	-216	.375	.140	.187	-273	.250	.147	1.000
-159	.203	.130	.281	-217	.375	.140	.250	-274	.312	.147	.125
-160	.255	.130	.190	-218	.375	.140	.312	-275	.312	.147	.187
-161	.375	.131	.220	-219	.375	.140	.375	-276	.312	.147	.250
-162	.220	.138	.656	-220	.375	.140	.437	-277	.312	.147	.312
-163	.187	.140	.125	-221	.375	.140	.500	-278	.312	.147	.375
-165	.218	.140	.156	-222	.375	.140	.562	-279	.312	.147	.437
-166	.250	.140	.125	-223	.375	.140	.625	-280	.312	.147	.500
-167	.250	.140	.160	-224	.375	.140	.687	-281	.312	.147	.625
-168	.250	.140	.187	-225	.375	.140	.750	-282	.312	.147	.750
-169	.250	.140	.210	-226	.375	.140	.812	-283	.312	.147	.875
-170	.250	.140	.250	-227	.375	.140	.875	-284	.312	.147	1.000
-171	.250	.140	.312	-228	.375	.140	.937	-285	.375	.147	.125
-172	.250	.140	.375	-229	.375	.140	1.000	-286	.375	.147	.187
-173	.250	.140	.437	-230	.375	.140	1.062	-287	.375	.147	.250
-174	.250	.140	.500	-231	.375	.140	1.125	-288	.375	.147	.312
-175	.250	.140	.547	-232	.375	.140	1.187	-289	.375	.147	.375
-176	.250	.140	.562	-233	.375	.140	1.250	-290	.375	.147	.437
-177	.250	.140	.625	-234	.375	.140	1.312	-291	.375	.147	.500
-178	.250	.140	.687	-235	.375	.140	1.375	-292	.375	.147	.625
-179	.250	.140	.750	-236	.375	.140	1.437	-293	.375	.147	.750
-180	.250	.140	.812	-237	.375	.140	1.500	-294	.375	.147	.875
-181	.250	.140	.875	-238	.400	.140	.718	-295	.375	.147	1.000
-182	.250	.140	.937	-239	.400	.140	.781	-296	.437	.147	.125
-183	.250	.140	1.000	-240	.500	.140	.125	-297	.437	.147	.187
-184	.250	.140	1.062	-241	.500	.140	.187	-298	.437	.147	.250
-185	.250	.140	1.125	-242	.500	.140	.250	-299	.437	.147	.312
-186	.250	.140	1.187	-243	.500	.140	.312	-300	.437	.147	.375
-187	.250	.140	1.250	-244	.500	.140	.375	-301	.437	.147	.437
-188	.250	.140	1.312	-245	.500	.140	.437	-302	.437	.147	.500
-189	.250	.140	1.375	-246	.500	.140	.500	-303	.437	.147	.625
-190	.250	.140	1.437	-247	.500	.140	.562	-304	.437	.147	.750
-191	.250	.140	1.500	-248	.500	.140	.625	-305	.437	.147	.875
-192	.312	.140	.125	-249	.500	.140	.687	-306	.437	.147	1.000
-193	.312	.140	.187	-250	.500	.140	.750	-307	.490	.150	.425
-194	.312	.140	.250	-251	.500	.140	.812				
-195	.312	.140	.281	-252	.500	.140	.875				

(continued next page)

Tolerances on all dimensions +/- .010

**.125 I.D. to .150 I.D.**

MACHINED HIGH PERFORMANCE PLASTIC SPACERS (continued)

\*Available in the following materials:

Material Code No.	Material Name	Material Code No.	Material Name	Material Code No.	Material Name	Material Code No.	Material Name
-11	Polypropylene	-32	PCTFE	-60	Nylon 6/6, 30% Short Glass -filled	-195	Nylon 46, 30% Glass-filled, Heat Stabilized, Flame Retardant
-15	PEEK™	-37	PVDF				
-27	PVC	-38	G-10 Fiber Glass	-194	Nylon 46, 30% Glass-filled, Heat Stabilized		
-28	CPVC	-40	Teflon®, (PFA)				
-29	Teflon®	-46	Polycarbonate				
-31	FEP	-62	Acetal				

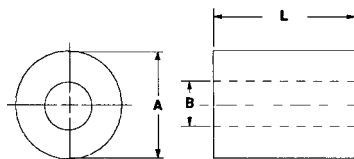

ROUND SPACERS

Part No. DN208 - (Size Code No.) - (Material Code No.)

Size Code No.	O.D. A	I.D. B	Lgth. L	Size Code No.	O.D. A	I.D. B	Lgth. L	Size Code No.	O.D. A	I.D. B	Lgth. L
-308	.510	.150	.310	-354	.312	.171	1.062	-400	.500	.171	.312
-309	.393	.151	.250	-355	.312	.171	1.125	-401	.500	.171	.375
-310	.251	.152	.156	-356	.312	.171	1.187	-402	.500	.171	.437
-311	.230	.155	.125	-357	.312	.171	1.250	-403	.500	.171	.500
-312	.687	.156	.125	-358	.312	.171	1.312	-404	.500	.171	.562
-313	.500	.158	.187	-359	.312	.171	1.375	-405	.500	.171	.625
-314	.377	.163	.125	-360	.312	.171	1.437	-406	.500	.171	.687
-315	.250	.165	.155	-361	.312	.171	1.500	-407	.500	.171	.750
-316	.375	.165	.100	-362	.375	.171	.125	-408	.500	.171	.812
-317	.500	.165	.165	-363	.375	.171	.187	-409	.500	.171	.875
-318	.570	.165	.250	-364	.375	.171	.203	-410	.500	.171	.937
-319	.605	.165	.370	-365	.375	.171	.250	-411	.500	.171	1.000
-320	.393	.169	.234	-366	.375	.171	.312	-412	.375	.174	.812
-321	.270	.170	.135	-367	.375	.171	.375	-413	.270	.175	.130
-322	.350	.170	.250	-368	.375	.171	.437	-414	.330	.183	.410
-323	.221	.171	.562	-369	.375	.171	.500	-415	.750	.185	.125
-324	.250	.171	.125	-370	.375	.171	.562	-416	.235	.187	.200
-325	.250	.171	.187	-371	.375	.171	.625	-417	.312	.187	.215
-326	.250	.171	.250	-372	.375	.171	.687	-418	.625	.187	.125
-327	.250	.171	.312	-373	.375	.171	.750	-419	1.312	.187	.562
-328	.250	.171	.375	-374	.375	.171	.812	-420	.312	.188	.312
-329	.250	.171	.437	-375	.375	.171	.875	-421	.316	.188	.203
-330	.250	.171	.500	-376	.375	.171	.937	-422	.250	.190	.280
-331	.250	.171	.562	-377	.375	.171	1.000	-423	.310	.190	.410
-332	.250	.171	.625	-378	.375	.171	1.062	-424	.330	.190	.410
-333	.250	.171	.687	-379	.375	.171	1.125	-425	.463	.190	.312
-334	.250	.171	.750	-380	.375	.171	1.187	-426	.495	.190	.415
-335	.250	.171	.812	-381	.375	.171	1.250	-427	.495	.190	.500
-336	.250	.171	.875	-382	.375	.171	1.312	-428	.495	.190	.620
-337	.250	.171	.937	-383	.375	.171	1.375	-429	.500	.190	.250
-338	.250	.171	1.000	-384	.375	.171	1.437	-430	.500	.190	1.740
-339	.312	.171	.125	-385	.375	.171	1.500	-431	.570	.190	.275
-340	.312	.171	.187	-386	.437	.171	.125	-432	.475	.191	.328
-341	.312	.171	.250	-387	.437	.171	.187	-433	.625	.191	.250
-342	.312	.171	.312	-388	.437	.171	.250	-434	.250	.192	.145
-343	.312	.171	.375	-389	.437	.171	.312	-435	.380	.192	.940
-344	.312	.171	.437	-390	.437	.171	.375	-436	.725	.192	.125
-345	.312	.171	.500	-391	.437	.171	.437	-437	.312	.194	.125
-346	.312	.171	.562	-392	.437	.171	.500	-438	.312	.194	.187
-347	.312	.171	.625	-393	.437	.171	.625	-439	.312	.194	.250
-348	.312	.171	.687	-394	.437	.171	.750	-440	.312	.194	.312
-349	.312	.171	.750	-395	.437	.171	.875	-441	.312	.194	.375
-350	.312	.171	.812	-396	.437	.171	1.000	-442	.312	.194	.437
-351	.312	.171	.875	-397	.500	.171	.125	-443	.312	.194	.500
-352	.312	.171	.937	-398	.500	.171	.187				
-353	.312	.171	1.000	-399	.500	.171	.250				

(continued next page)

Tolerances on all dimensions +/- .010

**.150 I.D. to .194 I.D.**

MACHINED HIGH PERFORMANCE PLASTIC SPACERS (continued)

**ROUND SPACERS**

Part No. DN208 - (Size Code No.) - (Material Code No.)

\*Available in other materials.  
See materials list in index.  
Other sizes available on request.

Size Code No.	O.D. A	I.D. B	Lgth. L	Size Code No.	O.D. A	I.D. B	Lgth. L	Size Code No.	O.D. A	I.D. B	Lgth. L
-444	.312	.194	.562	-501	.260	.200	.594	-558	.750	.200	.125
-445	.312	.194	.625	-502	.312	.200	.125	-559	.609	.202	.250
-446	.312	.194	.687	-503	.312	.200	.187	-560	.375	.203	.109
-447	.312	.194	.750	-504	.312	.200	.250	-561	.375	.203	.266
-448	.312	.194	.812	-505	.312	.200	.312	-562	.606	.203	.625
-449	.312	.194	.875	-506	.312	.200	.375	-563	.750	.203	.340
-450	.312	.194	.937	-507	.312	.200	.437	-564	.825	.203	.625
-451	.312	.194	1.000	-508	.312	.200	.500	-565	.430	.205	.250
-452	.312	.194	1.062	-509	.312	.200	.625	-566	.300	.210	.135
-453	.312	.194	1.125	-510	.312	.200	.750	-567	.375	.218	.125
-454	.312	.194	1.187	-511	.312	.200	.875	-568	.312	.219	.437
-455	.312	.194	1.250	-512	.312	.200	1.000	-569	.375	.219	.250
-456	.312	.194	1.312	-513	.375	.200	.125	-570	.500	.219	.125
-457	.312	.194	1.375	-514	.375	.200	.187	-571	.500	.219	.187
-458	.312	.194	1.437	-515	.375	.200	.250	-572	.500	.219	.250
-459	.312	.194	1.500	-516	.375	.200	.312	-573	.500	.219	.312
-460	.375	.194	.125	-517	.375	.200	.375	-574	.500	.219	.375
-461	.375	.194	.187	-518	.375	.200	.437	-575	.500	.219	.437
-462	.375	.194	.250	-519	.375	.200	.500	-576	.500	.219	.500
-463	.375	.194	.312	-520	.375	.200	.625	-577	.500	.219	.562
-464	.375	.194	.375	-521	.375	.200	.750	-578	.500	.219	.625
-465	.375	.194	.437	-522	.375	.200	.875	-577	.500	.219	.562
-466	.375	.194	.500	-523	.375	.200	1.000	-578	.500	.219	.625
-467	.375	.194	.562	-524	.437	.200	.125	-579	.500	.219	.687
-468	.375	.194	.625	-525	.437	.200	.187	-580	.500	.219	.750
-469	.375	.194	.687	-526	.437	.200	.250	-581	.500	.219	.812
-470	.375	.194	.750	-527	.437	.200	.312	-582	.500	.219	.875
-471	.375	.194	.812	-528	.437	.200	.375	-583	.500	.219	.937
-472	.375	.194	.875	-529	.437	.200	.437	-584	.500	.219	1.000
-473	.375	.194	.938	-530	.437	.200	.500	-585	.375	.220	.375
-474	.375	.194	1.000	-531	.437	.200	.625	-586	.945	.240	.062
-475	.375	.194	1.062	-532	.437	.200	.750	-587	.750	.245	.260
-476	.375	.194	1.125	-533	.437	.200	1.000	-588	.370	.250	.595
-477	.375	.194	1.187	-534	.495	.200	.180	-589	.375	.250	.220
-478	.375	.194	1.250	-535	.500	.200	.125	-590	.375	.250	.340
-479	.375	.194	1.312	-536	.500	.200	.187	-591	.375	.250	.500
-480	.375	.194	1.375	-537	.500	.200	.250	-592	.460	.250	.562
-481	.375	.194	1.437	-538	.500	.200	.312	-593	.490	.250	.220
-482	.375	.194	1.500	-539	.500	.200	.375	-594	.495	.250	.925
-483	.500	.194	.125	-540	.500	.200	.437	-595	.500	.250	.390
-484	.500	.194	.187	-541	.500	.200	.500	-596	.610	.250	.375
-485	.500	.194	.250	-542	.500	.200	.625	-597	.615	.250	.090
-486	.500	.194	.312	-543	.500	.200	.750	-598	.740	.250	.250
-487	.500	.194	.375	-544	.500	.200	.875	-599	.750	.250	.375
-488	.500	.194	.406	-545	.500	.200	1.000	-600	.750	.250	.500
-489	.500	.194	.437	-546	.562	.200	.125	-601	.870	.250	.255
-490	.500	.194	.500	-547	.562	.200	.187	-602	.389	.251	.125
-491	.500	.194	.562	-548	.562	.200	.250	-603	.375	.252	.375
-492	.500	.194	.625	-549	.562	.200	.312	-604	.385	.254	.240
-493	.500	.194	.687	-550	.562	.200	.375	-605	.375	.255	.250
-494	.500	.194	.750	-551	.562	.200	.437	-606	.750	.255	1.500
-495	.500	.194	.812	-552	.562	.200	.500	-607	.610	.256	1.500
-496	.500	.194	.875	-553	.625	.200	.125	-608	.375	.257	1.000
-497	.500	.194	.937	-554	.625	.200	.187	-609	.406	.257	1.000
-498	.500	.194	1.000	-555	.625	.200	.250	-610	.490	.257	.375
-499	.245	.195	.390	-556	.625	.200	.312				
-500	.500	.195	.187	-557	.735	.200	.250				

(continued next page)

Tolerances on all dimensions +/- .010

**.194 I.D. to .257 I.D.**

**MACHINED HIGH PERFORMANCE PLASTIC SPACERS (continued)**

\*Available in the following materials:

Material Code No.	Material Name	Material Code No.	Material Name	Material Code No.	Material Name	Material Code No.	Material Name
-11	Polypropylene	-32	PCTFE	-60	Nylon 6/6, 30% Short Glass -filled	-195	Nylon 46, 30% Glass-filled, Heat Stabilized, Flame Retardent
-15	PEEK™	-37	PVDF	-194	Nylon 46, 30% Glass-filled, Heat Stabilized		
-27	PVC	-38	G-10 Fiber Glass				
-28	CPVC	-40	Teflon®, (PFA)				
-29	Teflon®	-46	Polycarbonate				
-31	FEP	-62	Acetal				

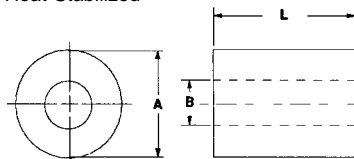

**ROUND SPACERS**

Part No. DN208 - (Size Code No.) - (Material Code No.)

Size Code No.	O.D. A	I.D. B	Lgth. L	Size Code No.	O.D. A	I.D. B	Lgth. L	Size Code No.	O.D. A	I.D. B	Lgth. L
-611	.500	.257	.125	-657	.750	.260	.125	-703	.570	.320	.547
-612	.500	.257	.187	-658	.370	.265	.156	-704	.975	.320	.420
-613	.500	.257	.234	-659	.375	.265	.250	-705	.625	.323	.187
-614	.500	.257	.250	-660	.375	.265	.375	-706	.390	.325	.240
-615	.500	.257	.312	-661	.375	.265	.500	-707	.450	.325	.422
-616	.500	.257	.375	-662	.375	.265	.750	-708	.500	.328	1.000
-617	.500	.257	.437	-663	.375	.265	.875	-709	.405	.330	.375
-618	.500	.257	.500	-664	.375	.265	1.000	-710	.448	.330	.422
-619	.500	.257	.562	-665	.406	.265	.750	-711	.484	.343	.187
-620	.500	.257	.625	-666	.635	.265	.875	-712	.480	.345	.187
-621	.500	.257	.687	-667	.406	.267	.500	-713	.620	.350	.187
-622	.500	.257	.750	-668	.406	.269	.250	-714	.984	.366	.375
-623	.500	.257	.812	-669	.625	.270	.218	-715	.750	.370	.343
-624	.500	.257	.875	-670	.940	.275	.062	-716	.500	.375	.030
-625	.500	.257	.937	-671	.380	.280	.255	-717	.500	.375	.437
-626	.500	.257	1.000	-672	.500	.280	.250	-718	.500	.375	.625
-627	.500	.257	1.375	-673	.500	.280	.255	-719	.500	.375	.687
-628	.500	.257	1.625	-674	.625	.280	.437	-720	.562	.375	.500
-629	.750	.258	.437	-675	.648	.280	.359	-721	.580	.375	.250
-630	.495	.260	.435	-676	.500	.281	.812	-722	.986	.375	.250
-631	.562	.260	.125	-677	.613	.281	.500	-723	2.000	.375	.500
-632	.562	.260	.187	-678	.615	.281	.812	-724	.500	.378	.750
-633	.562	.260	.250	-679	.625	.281	.750	-725	.560	.379	.375
-634	.562	.260	.312	-680	1.120	.281	.437	-726	.500	.380	.250
-635	.562	.260	.375	-681	.985	.285	.250	-727	.500	.380	.422
-636	.562	.260	.437	-682	.945	.290	.065	-728	.938	.380	.250
-637	.562	.260	.500	-683	.500	.310	.750	-729	.500	.385	.156
-638	.562	.260	.625	-684	.745	.310	.062	-730	.500	.385	1.000
-639	.562	.260	.750	-685	1.000	.310	.125	-731	.740	.385	.203
-640	.562	.260	.875	-686	.623	.311	.812	-732	.625	.386	.609
-641	.562	.260	1.000	-687	.425	.312	1.000	-733	.562	.388	.700
-642	.625	.260	.125	-688	.500	.312	.156	-734	.500	.390	.125
-643	.625	.260	.187	-689	.500	.312	.250	-735	.500	.390	.187
-644	.625	.260	.250	-690	.750	.312	.390	-736	.500	.390	.250
-645	.625	.260	.312	-691	.750	.312	.765	-737	.500	.390	.312
-646	.625	.260	.375	-692	.812	.312	.125	-738	.500	.390	.375
-647	.625	.260	.437	-693	.875	.312	.125	-739	.500	.390	.437
-648	.625	.260	.500	-694	.617	.313	.266	-740	.500	.390	.500
-649	.625	.260	.625	-695	.590	.314	.359	-741	.500	.390	.625
-650	.625	.260	.750	-696	.405	.315	.250	-742	.500	.390	.750
-651	.625	.260	.875	-697	.460	.315	.140	-743	.500	.390	.875
-652	.625	.260	1.000	-698	.750	.315	.100	-744	.500	.390	1.000
-653	.687	.260	.125	-699	.360	.316	.250	-745	.562	.390	.125
-654	.687	.260	.187	-700	.567	.318	.547	-746	.562	.390	.187
-655	.687	.260	.250	-701	.510	.320	.875				
-656	.687	.260	.312	-702	.550	.320	.435				

(continued next page)

Tolerances on all dimensions +/- .010

**.2570 I.D. to .390 I.D.**

## ROUND SPACERS

Part No. DN208 - (Size Code No.) - (Material Code No.)

\*Available in other materials.  
See materials list in index.  
Other sizes available on request.

Size Code No.	O.D. A	I.D. B	Lgth. L	Size Code No.	O.D. A	I.D. B	Lgth. L	Size Code No.	O.D. A	I.D. B	Lgth. L
-747	.562	.390	.250	-804	.750	.460	.250	-862	1.035	.900	.205
-748	.562	.390	.312	-805	.750	.460	.312	-863	1.750	.928	.281
-749	.562	.390	.375	-806	.750	.460	.375	-864	1.250	1.000	.250
-750	.562	.390	.437	-807	.750	.460	.437	-865	1.562	1.031	.187
-751	.562	.390	.500	-808	.750	.460	.500	-866	1.750	1.031	.150
-752	.562	.390	.625	-809	.750	.460	.625	-867	1.750	1.062	.150
-753	.562	.390	.750	-810	.750	.460	.750	-868	1.312	1.078	.750
-754	.562	.390	.875	-811	.750	.460	.875	-869	2.045	1.170	.450
-755	.562	.390	1.000	-812	.750	.460	1.000	-870	1.500	1.187	.359
-756	.625	.390	.125	-813	.750	.485	.310	-871	2.135	1.760	.125
-757	.625	.390	.187	-814	.750	.490	.343				
-758	.625	.390	.250	-815	.618	.500	.484				
-759	.625	.390	.312	-816	.625	.500	.511				
-760	.625	.390	.375	-817	.735	.500	.375				
-761	.625	.390	.437	-818	.987	.500	.375				
-762	.625	.390	.500	-819	1.250	.500	.250				
-763	.625	.390	.625	-820	1.375	.500	.125				
-764	.625	.390	.750	-821	.620	.504	.812				
-765	.625	.390	.875	-822	.718	.504	.385				
-766	.625	.390	1.000	-823	.668	.506	.937				
-767	.687	.390	.125	-824	.620	.507	1.687				
-768	.687	.390	.187	-825	.626	.507	.500				
-769	.687	.390	.250	-826	.775	.507	.250				
-770	.687	.390	.312	-827	.750	.515	.155				
-771	.687	.390	.375	-828	.656	.516	.500				
-772	.687	.390	.437	-829	.803	.520	.500				
-773	.687	.390	.500	-830	.875	.520	.200				
-774	.687	.390	.625	-831	1.000	.525	.500				
-775	.687	.390	.750	-832	.718	.526	.218				
-776	.687	.390	.875	-833	.718	.526	.281				
-777	.687	.390	1.000	-834	.750	.530	.230				
-778	.750	.390	.125	-835	1.000	.530	.125				
-779	.750	.390	.187	-836	.870	.531	.391				
-780	.750	.390	.250	-837	.840	.546	.215				
-781	.750	.390	.312	-838	2.000	.562	.125				
-782	.750	.390	.375	-839	.890	.575	.140				
-783	.870	.395	.130	-840	.750	.580	.820				
-784	1.000	.405	.100	-841	.900	.580	.150				
-785	.625	.425	.875	-842	.700	.600	.140				
-786	.625	.437	.250	-843	1.250	.625	.250				
-787	.625	.440	.125	-844	1.380	.625	.505				
-788	.870	.440	.130	-845	.800	.640	.125				
-789	.570	.450	.030	-846	1.320	.640	.250				
-790	.625	.450	.875	-847	1.040	.650	.170				
-791	.687	.460	.125	-849	1.375	.656	.125				
-792	.687	.460	.187	-850	1.750	.687	.250				
-793	.687	.460	.250	-851	.875	.690	.156				
-794	.687	.460	.312	-852	1.062	.740	.187				
-795	.687	.460	.375	-853	1.250	.750	.250				
-796	.687	.460	.437	-854	1.620	.750	.125				
-797	.687	.460	.500	-855	1.000	.755	.203				
-799	.687	.460	.625	-856	1.000	.760	.165				
-799	.687	.460	.750	-857	1.515	.765	.250				
-800	.687	.460	.875	-858	1.000	.800	.195				
-801	.687	.460	1.000	-859	1.057	.812	.125				
-802	.750	.460	.125	-860	1.312	.812	.562				
-803	.750	.460	.187	-861	1.250	.875	.250				

Tolerances on all dimensions +/- .010

**.390 I.D. to 1.760 I.D.**

# MACHINED FLUOROPLASTIC SPACERS

\*Available in other materials. See materials list in index.  
Other sizes available on request.

\*Available in the following materials:

Material Code No.	Material Name	Material Code No.	Material Name
-29	Teflon®	-37	PVDF
-30	Tefzel®	-40	PFA, (Teflon®)
-31	FEP®	-41	Halar®
-32	PCTFE		

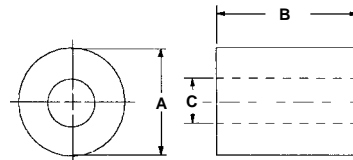

## ROUND SPACERS

Part No. D208 - (Size Code No.) - (Material Code No.)

Size Code No.	A	B	C	Screw Size	Size Code No.	A	B	C	Screw Size
-1	.145	.390	.095	#2	-45	.500	.250	.190	#10
-2	.200	.125	.100	#4	-46	.500	.375	.190	#10
-3	.225	.145	.115	#4	-47	.500	.255	.260	#1/4
-4	.230	.125	.155	#6	-48	.500	1.740	.190	#10
-5	.245	.390	.195	#10	-49	.510	.310	.150	#6
-6	.250	.280	.190	#10	-50	.550	.435	.320	#5/16
-7	.250	.185	.075	#2	-51	.570	.250	.165	#8
-8	.250	.155	.165	#8	-52	.570	.275	.190	#10
-9	.250	.715	.125	#4	-53	.570	.030	.450	#7/16
-10	.255	.190	.130	#4	-54	.580	.250	.375	#3/8
-11	.270	.135	.170	#8	-55	.612	.235	.060	—
-12	.270	.130	.175	#8	-56	.605	.370	.165	#8
-13	.300	.135	.210	#10	-57	.615	.090	.250	#1/4
-14	.305	.155	.125	#4	-58	.625	.125	.440	#7/16
-15	.350	.250	.170	#8	-59	.635	.875	.265	#1/4
-16	.350	.062	.180	#8	-60	.700	.140	.600	#9/16
-17	.365	.062	.125	#4	-61	.735	.250	.200	#10
-18	.365	.120	.120	#4	-62	.735	.375	.500	#7/16
-19	.370	.595	.250	#1/4	-63	.745	.062	.310	#5/16
-20	.375	.250	.255	#1/4	-64	.750	.310	.485	#7/16
-21	.375	.100	.165	#8	-65	.750	.820	.580	#9/16
-22	.375	.500	.250	#1/4	-66	.750	1.500	.255	#1/4
-23	.375	.110	.105	#4	-67	.750	.100	.315	#5/16
-24	.375	.340	.250	#1/4	-68	.750	.155	.515	#1/2
-25	.375	.812	.174	#8	-69	.870	.255	.250	#1/4
-26	.380	.255	.280	#1/4	-70	.870	.130	.395	#3/8
-27	.405	.250	.315	#5/16	-71	.870	.130	.440	#7/16
-28	.405	.375	.330	#5/16	-72	.940	.062	.275	#1/4
-29	.425	1.000	.312	#5/16	-73	.945	.062	.240	#12
-30	.430	.250	.205	#10	-74	.945	.065	.290	#1/4
-31	.460	.140	.315	#5/16	-75	.975	.420	.320	#5/16
-32	.490	.220	.250	#1/4	-76	1.000	.195	.800	#3/4
-33	.490	.425	.150	#6	-77	1.000	.165	.760	#3/4
-34	.495	.180	.200	#10	-78	1.000	.100	.405	#3/8
-35	.495	.435	.260	#1/4	-79	1.000	.125	.310	#5/16
-36	.490	.110	.120	#4	-80	1.035	.205	.900	#7/8
-37	.495	.415	.190	#10	-81	1.250	.250	.500	#7/16
-38	.495	.500	.190	#10	-82	1.250	.250	1.000	#1
-39	.495	.620	.190	#10	-83	1.250	.250	.875	#7/8
-40	.495	.925	.250	#1/4	-84	1.250	.250	.625	#5/8
-41	.500	.165	.165	#8	-85	1.250	.250	.750	#3/4
-42	.500	.030	.375	#3/8	-86	1.320	.250	.640	#5/8
-43	.500	.750	.310	#5/16	-87	1.380	.505	.625	#5/8
-44	.500	.187	.195	#10	-88	1.510	.250	.765	#3/4