

# WIRE HANDLING HARDWARE AND ACCESSORIES

## CONTOUR CLIP

Available in the following materials:

Material Code No.	Material Name
-18	Nylon 6/6, (natural)

*Flexible base of this contour clip allows use on cylindrical surfaces such as pipes or tubing, and on irregular surfaces including around corners.*

**Part No. P520** - (Size Code No.) - 18

Size Code No.	Size
-1	See drawing

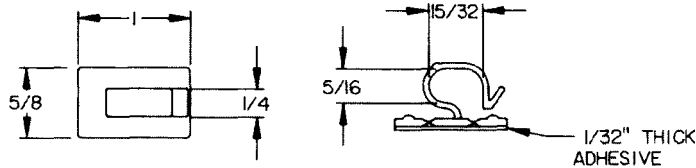

## SPRING CLIP

Available in the following materials:

Material Code No.	Material Name
-18	Nylon 6/6, (natural)
-78	Nylon 6/6, (black)

*This spring clip provides fast, secure assembly and routing of wires, standard round cable, flat cable and tubing. Can also be used to mount panels, glass, displays or signs.*

**Part No. C626** - (Size Code No.) - (Material Code No.)

Size Code No.	Size
-1	3/8 x 1.312

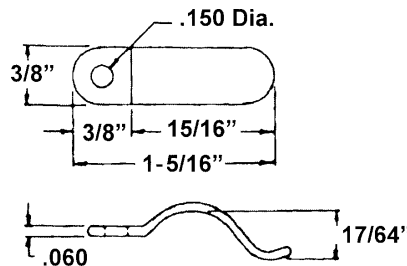

## WIRE CLIPS

Available in the following materials:

Material Code No.	Material Name
-18	Nylon 6/6, (natural)
-78	Nylon 6/6, (black)

*This spring clip provides fast, secure assembly and routing of wires, standard round cable, flat cable and tubing.*

**Part No. C627** - (Size Code No.) - (Material Code No.)

Size Code No.	Size
-1	1/2 x .312

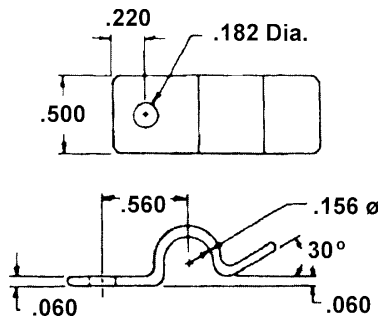

## RELEASABLE WIRE and CABLE CLIPS

Available in the following materials:

Material Code No.	Material Name
-18	Nylon 6/6, (natural)

*These releasable adhesive backed clips are used to route wires and cables. Clip is backed with Polyethylene foam tape and features a releasable clip.*

**Part No. C628** - (Size Code No.) - 18

Size Code No.	Size
-1	See drawing

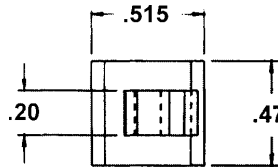

All dimensions +/- .015"

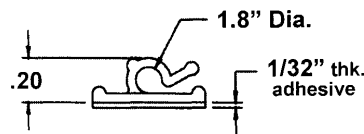

**Part No. C629** - (Size Code No.) - 18

Size Code No.	Size
-1	See drawing

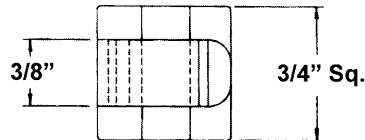

All dimensions +/- .015"

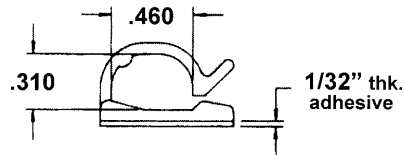

**Part No. C630** - (Size Code No.) - 18

Size Code No.	Size
-1	See drawing

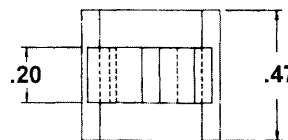

All dimensions +/- .015"

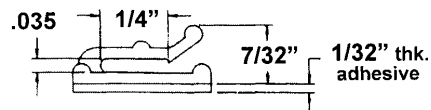

## RELEASABLE WIRE and CABLE CLIPS

Available in the following materials:

**Material Code No.**    **Material Name**  
 -18                      Nylon 6/6, (natural)

*These releasable adhesive backed clips are used to route wires and cables. Clip is backed with Polyethylene foam tape and features a releasable clip.*

### Part No. P500 - (Size Code No.) - 18

Size Code No.	Size
-1	See drawing

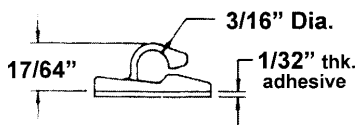
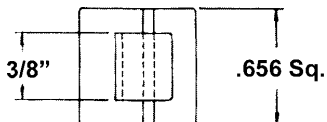

All dimensions +/- .015"

### Part No. P501 - (Size Code No.) - 18

Size Code No.	Size
-1	See drawing

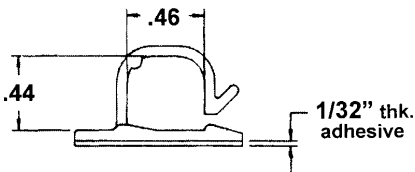
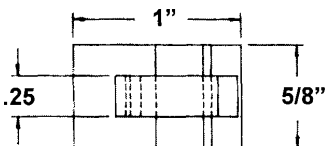

All dimensions +/- .015"

### Part No. P502 - (Size Code No.) - 18

Size Code No.	Size
-1	See drawing

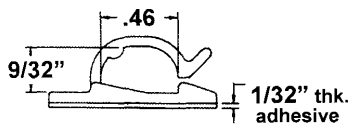
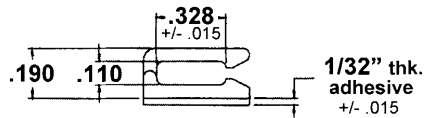
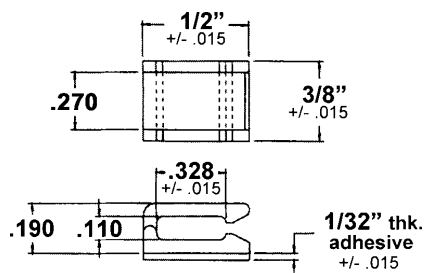

### Part No. P503 - (Size Code No.) - 18

Size Code No.	Size
-1	See drawing

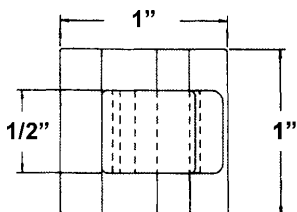

All dimensions +/- .015"

WIRE HANDLING HARDWARE AND ACCESSORIES (continued)

Available in the following materials:

Material Code No.	Material Name
-18	Nylon 6/6, (natural)
-78	Nylon 6/6, (black)

*EZ twist locks offer a fast, economical way to securely position and hold wire, cable or tubing. A single twist of the finger locks the bundle together and another twist will open the lock for removals or additions.*

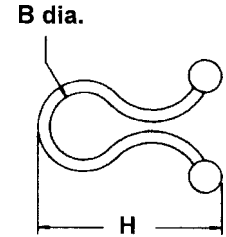

## EZ TWIST LOCKS

Part No. C1003 - (Size Code No.) - (Material Code No.)

Size Code No.	Description	H	B	Size Code No.	Description	H	B
-1	1/8" LOCK	.715	.11/.14	-7	15/16" LOCK	1.870	.90/1.00
-2	1/4" LOCK	.875	.20/.27	-8	1 1/8" LOCK	2.170	1.20/1.30
-3	3/8" LOCK	1.080	.30/.40	-9	1 3/8" LOCK	2.670	1.45/1.55
-4	1/2" LOCK	1.200	.40/.50	-10	1 1/2" LOCK	2.930	1.55/1.65
-5	5/8" LOCK	1.260	.55/.65	-11	1 3/4" LOCK	3.460	1.90/2.00
-6	3/4" LOCK	1.550	.70/.80				

## DOUBLE EZ TWIST LOCKS

Available in the following materials:

Material Code No.	Material Name
-18	Nylon 6/6, (natural)
-78	Nylon 6/6, (black)

Part No. C1004 - (Size Code No.) - (Material Code No.)

Size Code No.	H	L	B1 and B2
-1	2-3/4	11/16	.30/.40
-2	2-31/32	11/16	.40/.50

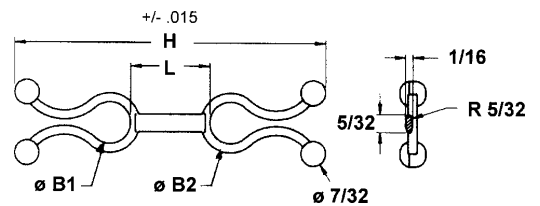

## EZ TWIST LOCK on FIN CLIP BASE

Part No. C661 - (Size Code No.) - (Material Code No.)

Size Code No.	Bundle Dia.	Standoff Length	Mounting Hole	Panel Range
-1	3/8	1/4	.189	1/32-1/4
-2	3/8	3/8	.189	1/32-1/4
-3	3/8	1/2	.189	1/32-1/4
-4	3/8	5/8	.189	1/32-1/4
-5	1/2	3/8	.250	1/32-1/4
-6	1/2	1/2	.250	1/32-1/4
-7	1/2	5/8	.250	1/32-1/4
-8	1/2	1	.250	1/32-1/4

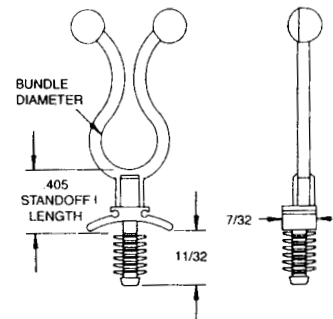

## EZ TWIST LOCK SUPPORTS

Available in the following materials:

**Material**

Code No.	Material Name
-18	Nylon 6/6, (natural)
-78	Nylon 6/6, (black)

*These EZ twist lock printed circuit board supports feature a uniquely designed locking base which is easily snapped into the chassis by hand. Cables and wires can be loaded and unloaded with a simple twist of the fingers and are supported above the board eliminating possible contact with hot components.*

**Part No. C1000 - (Size Code No.) - (Material Code No.)**

Size Code No.	Description	A	B	C
-1	.250 BUNDLE DIA.	.954	.876	.276
-2	.450 BUNDLE DIA.	.028	1.180	.453
-3	.200 BUNDLE DIA.	.011	.844	.205
-4	.375 BUNDLE DIA.	.050	1.066	.350
-5	.450 BUNDLE DIA.	.625	1.184	.453
-6	.625 BUNDLE DIA.	.028	1.270	.620

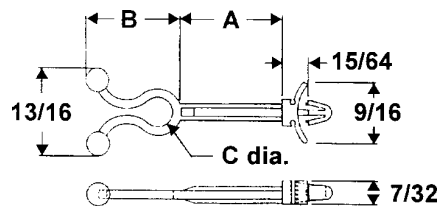

**Part No. C1001 - (Size Code No.) - (Material Code No.)**

Size Code No.	Description	Panel Thickness	H	W
-1	.250 BUNDLE DIA.	1/16	7/8	23/32
-2	.375 BUNDLE DIA.	1/16	1-5/64	3/4
-3	.500 BUNDLE DIA.	1/16	1-13/64	7/8

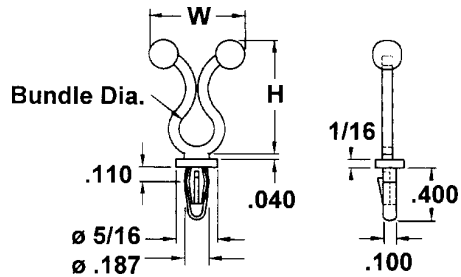

**Part No. C1002 - (Size Code No.) - (Material Code No.)**

Size Code No.	Description	Panel Thickness	H	W
-1	.250 BUNDLE DIA.	.047	7/8	23/32
-2	.375 BUNDLE DIA.	.047	1-5/64	3/4
-3	.500 BUNDLE DIA.	.047	1-13/64	7/8

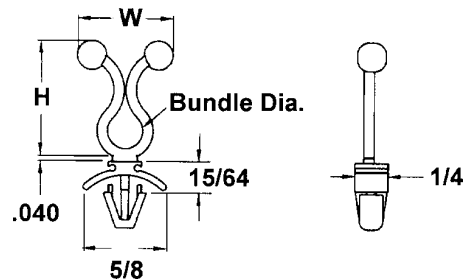

## RELEASABLE CLAMP on FIN CLIP BASE

Available in the following materials:

**Material**

Code No.	Material Name
-18	Nylon 6/6, (natural)
-78	Nylon 6/6, (black)

**Part No. C660** - (Size Code No.) - (Material Code No.)

Size Code No.	Hole Dia.	Bundle Dia.	A	B	C
-1	.187	.375	.344	.562	.187
-2	.187	.500	.344	.562	.187
-3	.250	.500	.344	.562	.187
-4	.250	.500	.344	.625	.375

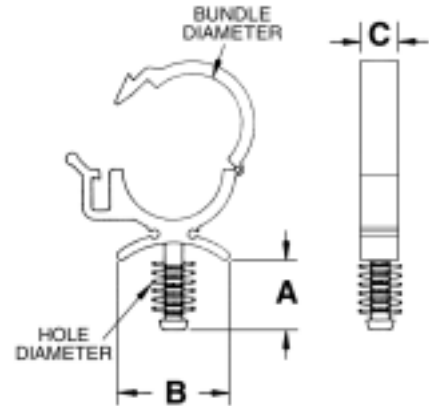

## BEADED TIES

Available in the following materials:

**Material**

Code No.	Material Name
-18	Nylon 6/6, (natural)
-78	Nylon 6/6, (black)

*This beaded tie's smooth, rounded configuration eliminates damage to wire and cable insulation. Ties can be disassembled and reused.*

**Part No. C135** - (Size Code No.) - (Material Code No.)

Size Code No.	Description	Length
-210	425 N	4 1/2
-220	600 N	6
-225	800 N	8
-230	1000 N	10

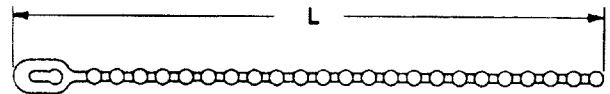

WIRE HANDLING HARDWARE AND ACCESSORIES (continued)

**CABLE CLAMPS**

Part No. CN611 - (Size Code No.) - (Material Code No.)

Size Code No.	A		B		D		C		T
	In.	mm	In.	mm	In.	mm	In	mm	In
-1	1/16	0,79	5/32	3,97	.096	2,44	.187	4,75	.030
-2	3/32	2,38	5/32	3,97	.096	2,44	.203	5,16	.030
-3	1/8	3,18	5/32	3,97	.096	2,44	.217	5,51	.030
-4	5/32	3,97	5/32	3,97	.096	2,44	.233	5,92	.030
-5	3/16	4,76	5/32	3,97	.096	2,44	.250	6,35	.030
-6	1/4	6,35	9/32	7,14	.128	3,25	.337	8,56	.030
-7	3/8	9,52	9/32	7,14	.128	3,25	.400	10,16	.030
-8	1/8	3,18	3/8	9,53	.140	3,56	.329	8,36	.050
-9	1/8	3,18	3/8	9,53	.167	4,24	.329	8,36	.050
-10	1/8	3,18	3/8	9,53	.203	5,16	.329	8,36	.050
-11	3/16	4,76	3/8	9,53	.140	3,56	.430	10,92	.050
-12	3/16	4,76	3/8	9,53	.167	4,24	.430	10,92	.050
-13	3/16	4,76	3/8	9,53	.203	5,16	.430	10,92	.050
-14	3/16	4,76	3/8	9,53	.140	3,56	.378	9,60	.050
-15	3/16	4,76	3/8	9,53	.167	4,24	.378	9,60	.050
-16	3/16	4,76	3/8	9,53	.203	5,16	.378	9,60	.050
-17	1/4	6,35	3/8	9,53	.140	3,56	.410	10,41	.050
-18	1/4	6,35	3/8	9,53	.167	4,24	.410	10,41	.050
-19	1/4	6,35	3/8	9,53	.203	5,16	.410	10,41	.050
-20	5/16	7,94	3/8	9,53	.140	3,56	.495	12,57	.050
-21	5/16	7,94	3/8	9,53	.167	4,24	.495	12,57	.050
-22	5/16	7,94	3/8	9,53	.203	5,16	.495	12,57	.050
-23	3/8	9,53	3/8	9,53	.140	3,56	.595	15,11	.050
-24	3/8	9,53	3/8	9,53	.167	4,24	.595	15,11	.050
-25	3/8	9,53	3/8	9,53	.203	5,16	.595	15,11	.050
-26	7/16	11,11	3/8	9,53	.140	3,56	.574	14,58	.050
-27	7/16	11,11	3/8	9,53	.167	4,24	.574	14,58	.050
-28	7/16	11,11	3/8	9,53	.203	5,16	.574	14,58	.050
-29	1/2	12,70	3/8	9,53	.140	3,56	.605	15,37	.050
-30	1/2	12,70	3/8	9,53	.167	4,24	.605	15,37	.050
-31	1/2	12,70	3/8	9,53	.203	5,16	.605	15,37	.050
-32	9/16	14,29	3/8	9,53	.203	5,16	.606	15,39	.050
-33	5/8	15,88	3/8	9,53	.203	5,16	.678	17,22	.050
-34	1/8	3,18	1/2	12,70	.167	4,24	.315	8,00	.050
-35	1/8	3,18	1/2	12,70	.203	5,16	.315	8,00	.050
-36	3/16	4,76	1/2	12,70	.167	4,24	.425	10,80	.050
-37	3/16	4,76	1/2	12,70	.203	5,16	.425	10,80	.050
-38	1/4	6,35	1/2	12,70	.167	4,24	.410	10,41	.050
-39	1/4	6,35	1/2	12,70	.203	5,16	.410	10,41	.050
-40	5/16	7,94	1/2	12,70	.167	4,24	.500	12,70	.050
-41	5/16	7,94	1/2	12,70	.203	5,16	.500	12,70	.050
-42	3/8	9,53	1/2	12,70	.167	4,24	.530	13,46	.050
-43	3/8	9,53	1/2	12,70	.203	5,16	.530	13,46	.050
-430	3/8	9,53	1/2	12,70	.253	6,35	.585	14,86	.050
-44	7/16	11,11	1/2	12,70	.167	4,24	.560	14,22	.050
-45	7/16	11,11	1/2	12,70	.203	5,16	.560	14,22	.050
-46	1/2	12,70	1/2	12,70	.167	4,24	.595	15,11	.050
-47	1/2	12,70	1/2	12,70	.203	5,16	.595	15,11	.050
-48	9/16	14,29	1/2	12,70	.167	4,24	.606	15,39	.050
-49	9/16	14,29	1/2	12,70	.203	5,16	.606	15,39	.050
-50	5/8	15,88	1/2	12,70	.167	4,24	.655	16,64	.050
-51	5/8	15,88	1/2	12,70	.203	5,16	.655	16,64	.050
-52	11/16	17,46	1/2	12,70	.167	4,24	.755	19,18	.050
-53	11/16	17,46	1/2	12,70	.203	5,16	.755	19,18	.050
-54	3/4	19,05	1/2	12,70	.167	4,24	.780	19,81	.050
-55	3/4	19,05	1/2	12,70	.203	5,16	.780	19,81	.050
-56	13/16	20,64	1/2	12,70	.167	4,24	.815	20,70	.050
-57	13/16	20,64	1/2	12,70	.203	5,16	.815	20,70	.050
-58	7/8	22,22	1/2	12,70	.167	4,24	.845	21,46	.050
-59	7/8	22,22	1/2	12,70	.203	5,16	.845	21,46	.050
-60	1	25,40	1/2	12,70	.203	5,16	.910	23,11	.050
-61	1 1/8	28,58	1/2	12,70	.203	5,16	.970	24,64	.050
-62	1 3/16	30,16	1/2	12,70	.203	5,16	1.000	25,40	.050
-63	1 1/4	31,75	1/2	12,70	.203	5,16	1.060	26,92	.050
-64	1 3/8	34,93	1/2	12,70	.203	5,16	1.125	28,58	.050
-65	1 1/2	38,10	1/2	12,70	.203	5,16	1.190	30,23	.050
-66	3/4	19,05	7/8	22,22	.387	9,83	1.000	25,40	.050
-660	1 1/32	26,19	7/8	22,22	.203	9,83	1.125	28,58	.050
-67	1 1/32	26,19	7/8	22,22	.387	9,83	1.125	28,58	.050

These tough, durable and chemically resistant molded Nylon cable clamps secure, insulate and route cable, wiring, tubing, piping and fibre optics.

Clamps are used in electronics, automotive, air craft, appliance and many other industrial applications.

Available in the following materials:

Material Code No.	Material Name
-18	Nylon 6/6, (natural)
-78	Nylon 6/6, (black)

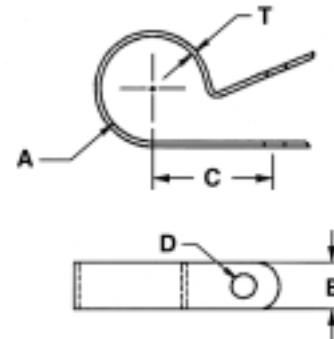

C and D dimensions are +/- .015".

## CABLE CLAMPS

These cable clamps are used for clamping cable or tubing securely into place. Resists corrosion, salt water, weak acids, gasoline, alcohol, oil, grease and other common solvents. Material is 6/6 nylon with Flammability Rating 94V-2. Maximum Temperature 185° F (85°C).

Available in the following materials:

**Material Code No. Material Name**

- 18 Nylon 6/6, (natural)
- 78 Nylon 6/6, (black)

**Part No. C611** - (Size Code No.) - (Material Code No.)

Size Code No.	Dimensions				Screw Size				
	A Dia.		B			D Dia.		T	
	in.	m m	in.	m m	in.	m m	in.	m m	
-1	.125	3,2							8
-2	.187	4,7							
-3	.250	6,4			.170	4,3			
-5	.312	7,9							
-6	.375	9,5							
-7	.437	11,1							
-8	.500	12,7	.375	9,5			.050	1,3	
-80	.125	3,2							
-81	.187	4,7							
-82	.250	6,4			.203	5,2			
-83	.312	7,9							
-84	.375	9,5							
-85	.437	11,1							
-86	.500	12,7							
-9	.125	3,1							.060 1,5
-10	.187	4,8							
-11	.250	6,4							
-12	.312	7,9							
-13	.375	9,5							
-14	.437	11,1							
-15	.500	12,7							
-16	.562	14,3							
-17	.625	15,9							
-18	.687	17,5	.500	12,7					
-19	.750	19,1							
-20	.812	20,7							
-21	.875	22,2							
-22	1.000	25,4							
-23	1.125	28,6							
-24	1.187	30,2							
-25	1.250	31,8							
-26	1.375	34,9							
-27	1.500	38,1							

