

# PANEL FASTENERS and HOLE PLUGS

## PUSH-IN-FASTENERS

Available in the following materials:

Material Code No.	Material Name
-18	Nylon 6/6, (natural)
-78	Nylon 6/6, (black)

These push-in-fasteners feature large heads for easier assembly and can be used over and over. Specially designed legs provide compression and expansion to lock fastener into pre-punched holes. Fastener is used to join plastic, light sheet metal, insulating materials, circuit boards or any other thin, light-weight material. Can also be used as push-in glides or as bumpers.

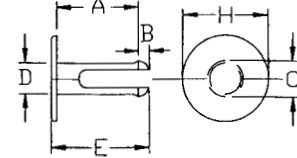

Part No. PN102 - (Size Code No.) - (Material Code No.)

Size Code No.	H	A	B	C	D	E	Size Code No.	H	A	B	C	D	E
-2000	.500	.220	.110	.200	.148	.400	-19	11/32	.197	.185	.295	.255	.415
-2002	13/64	.208	.083	.140	.115	.320	-20	11/32	.555	.145	.225	.180	.770
-2004	.175	.268	.090	.140	.096	.400	-21	9/64	.315	.075	.135	.095	.450
-2006	.135	.125	.070	.110	.089	.235	-22	7/16	.120	.255	.380	.305	.445
-1000	3/8	1.062	.177	.202	.165	1.303	-23	15/32	.121	.153	.238	.200	.324
-1001	11/32	.875	.174	.224	.175	1.115	-24	15/32	.156	.125	.228	.200	.333
-1002	13/64	.210	.091	.179	.130	.342	-25	11/32	.370	.105	.236	.203	.540
-1003	25/64	.503	.210	.295	.230	1.083	-26	25/64	1.730	.210	.295	.230	2.010
-1004	13/64	.235	.066	.145	.115	.341	-27	29/64	.276	.142	.295	.240	.460
-1006	3/4	.636	.180	.220	.180	.875	-28	29/64	.300	.170	.295	.240	.535
-1005	3/8	.505	.130	.200	.130	.705	-29	19/32	.480	.187	.293	.245	.720
-1007	5/16	.125	.070	.110	.089	.235	-30	29/64	.330	.165	.295	.240	.555
-1008	3/16	.533	.087	.130	.095	.675	-31	1/2	.171	.187	.295	.260	.405
-1009	.248	.813	.140	.144	.110	1.017	-310	11/16	.140	.255	.360	.290	.468
-1010	21/64	.030	.130	.162	.152	.200	-312	.312	.095	.075	.145	.095	.218
-1011	11/32	.130	.110	.200	.160	.270	-32	19/32	.171	.187	.295	.260	.418
-1012	13/64	.230	.098	.156	.128	.370	-333	19/32	.250	.187	.290	.245	.497
-1013	1/4	.445	.085	.145	.095	.590	-34	19/32	.365	.187	.290	.245	.622
-1014	15/64	.080	.080	.180	.124	.200	-35	11/32	.171	.187	.295	.260	.380
-1015	.186	.200	.065	.104	.080	.297	-36	19/32	.405	.160	.315	.275	.620
-1016	1/2	.064	.185	.280	.243	.370	-37	1/4	.550	.135	.145	.112	.745
-1017	3/16	.075	.060	.150	.120	.190	-38	15/32	.129	.148	.238	.197	.399
-1018	19/32	.365	.187	.295	.245	.685	-39	15/64	.320	.084	.145	.118	.437
-1019	15/64	1.010	.082	.164	.124	1.130	-40	1/2	.064	.138	.280	.243	.292
-1030	15/64	.080	.070	.180	.124	.205	-41	1/2	.099	.168	.280	.245	.324
-1020	19/32	.250	.187	.300	.245	.497	-42	1/2	.127	.177	.281	.241	.361
-1021	13/32	.250	.100	.278	.217	.395	-43	1/2	.156	.170	.281	.242	.380
-1022	9/16	.950	.174	.228	.172	1.200	-44	1/2	.189	.177	.278	.241	.426
-1023	3/8	1.543	.205	.295	.250	1.875	-45	1/2	.219	.178	.277	.239	.445
-1024	.680	.154	.255	.347	.285	.473	-46	1/2	.250	.175	.283	.241	.487
-1025	.300	.050	.137	.202	.165	.337	-47	1/2	.281	.176	.280	.240	.513
-1026	15/64	.750	.082	.164	.120	.875	-48	1/2	.314	.176	.281	.241	.547
-1027	5/8	1.065	.360	.360	.270	1.500	-49	1/2	.345	.177	.281	.240	.578
-1028	.380	.340	.180	.220	.180	.580	-50	1/2	.375	.175	.281	.242	.609
-1	3/16	.066	.075	.100	.090	.179	-51	1/2	.405	.175	.282	.243	.638
-2	3/8	.636	.180	.220	.180	.875	-52	19/32	.130	.125	.205	.145	.305
-3	9/32	.063	.078	.100	.093	.165	-53	1/2	.466	.178	.280	.240	.701
-4	1/4	.115	.085	.145	.093	.240	-54	1/2	.498	.176	.280	.240	.734
-5	9/32	.093	.078	.105	.093	.200	-55	1/2	.438	.176	.281	.240	.672
-6	5/16	.121	.085	.145	.089	.246	-56	3/16	.145	.065	.105	.090	.255
-7	13/64	.190	.090	.180	.130	.320	-560	1/2	1.020	.380	.475	.350	1.460
-8	13/64	.156	.135	.140	.115	.320	-562	3/8	1.125	.170	.202	.165	1.365
-9	13/64	.135	.135	.140	.115	.295	-564	.343	.125	.137	.202	.165	.310
-10	13/64	.235	.070	.137	.115	.345	-566	11/16	.250	.255	.360	.290	.585
-11	13/64	.250	.106	.145	.115	.395	-568	.310	.195	.200	.200	.160	.450
-12	13/64	.121	.105	.145	.115	.260	-570	.155	.460	.085	.135	.093	.595
-13	25/64	.315	.113	.208	.157	.488	-572	15/64	.080	.060	.200	.160	.180
-14	11/32	.450	.160	.200	.160	.680	-574	3/16	.145	.090	.135	.090	.300
-15	11/32	.125	.137	.202	.165	.305	-576	.320	.130	.110	.220	.195	.290
-16	11/32	.065	.137	.202	.165	.325	-578	.320	.180	.110	.220	.195	.340
-17	11/32	.556	.153	.225	.180	.780	-580	.344	.560	.145	.224	.175	.765
-18	11/32	.242	.174	.224	.175	.490							

Note: Size Code Nos. -3, -5, -6 and -312 have no slot.

PANEL FASTENERS and HOLE PLUGS (continued)

### "SPECIAL ITEM" PUSH-IN-FASTENER

Available in the following materials:

Material Code No.	Material Name
-18	Nylon 6/6, (natural)
-78	Nylon 6/6, (black)

Part No. PN170 - 1 - (Material Code No.)

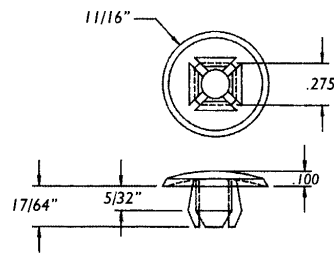

### SNAP RIVETS

Available in the following materials:

Material Code No.	Material Name
-78	Nylon 6/6, (black)

*This 2 piece fastener comes assembled and ready for use. The rivet is placed in hole and the smooth, oversized head is pressed. The specially designed legs expand and firmly lock the components permanently in place.*

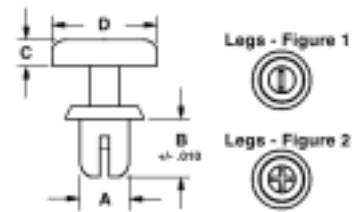

Part No. PN135 - (Size Code No.) - (Material Code No.)

Size Code No.	A	+/- .010 B	Head Hgt. C	Head Dia. D	Panel Thkness	Hole Size	Leg Fig. #	Size Code No.	A	+/- .010 B	Head Hgt. C	Head Dia. D	Panel Thkness	Hole Size	Leg Fig. #
-101	.076	.090	.047	.165	.024/.047	.083/.087	1	-3	.155	.200	.082	.316	.100/.140	.160/.164	1
-102	.076	.013	.047	.165	.051/.079	.083/.087	1	-4	.155	.240	.078	.317	.144/.188	.160/.164	1
-103	.076	.160	.025	.123	.083/.110	.083/.087	1	-124	.157	.284	.084	.318	.175/.215	.162/.166	2
-104	.076	.190	.047	.165	.114/.142	.083/.087	1	-52	.157	.395	.083	.315	.290/.330	.162/.166	2
-105	.076	.250	.047	.165	.173/.197	.083/.087	1	-53	.157	.315	.083	.317	.148/.188	.162/.166	2
-106	.100	.125	.062	.203	.035/.080	.105/.109	2	-6	.157	.236	.081	.375	.050/.180	.162/.166	1
-107	.100	.130	.055	.197	.039/.079	.102/.106	1	-125	.157	.350	.071	.318	.256/.295	.161/.165	2
-108	.100	.190	.055	.197	.106/.142	.102/.106	1	-126	.157	.390	.071	.317	.295/.335	.161/.165	2
-109	.100	.220	.027	.147	.134/.169	.102/.106	1	-10	.160	.315	.034	.278	.100/.250	.165/.169	2
-110	.102	.200	.064	.201	.125/.156	.107/.111	2	-7	.166	.265	.084	.315	.170/.210	.171/.175	1
-50	.102	.170	.067	.203	.078/.118	.107/.111	2	-127	.182	.530	.098	.356	.250/.437	.187/.191	2
-1	.118	.140	.065	.254	.050/.100	.123/.127	2	-128	.195	.180	.087	.350	.059/.098	.201/.205	2
-111	.118	.183	.062	.245	.075/.120	.123/.127	1	-129	.195	.220	.087	.350	.098/.138	.201/.205	2
-112	.118	.260	.063	.252	.157/.197	.122/.126	1	-130	.195	.260	.038	.264	.105/.170	.201/.205	2
-113	.118	.310	.063	.252	.217/.256	.122/.126	1	-131	.195	.410	.087	.350	.295/.335	.201/.205	2
-114	.118	.350	.063	.252	.256/.295	.123/.127	1	-132	.195	.330	.087	.350	.138/.177	.201/.205	2
-115	.118	.390	.063	.252	.295/.335	.122/.126	1	-133	.197	.330	.085	.356	.217/.256	.202/.206	2
-116	.118	.180	.063	.252	.079/.118	.122/.126	1	-9	.198	.368	.095	.352	.230/.300	.203/.207	2
-2	.122	.220	.065	.249	.122/.160	.127/.131	1	-5	.200	.280	.064	.350	.160/.200	.205/.209	2
-117	.135	.180	.061	.253	.060/.120	.140/.144	2	-134	.236	.240	.040	.345	.098/.157	.240/.244	2
-51	.135	.220	.060	.252	.118/.157	.140/.144	2	-135	.236	.231	.118	.472	.138/.217	.240/.244	2
-118	.135	.140	.063	.252	.047/.083	.142/.146	2	-136	.240	.187	.120	.440	.031/.062	.250	2
-119	.135	.170	.063	.252	.083/.118	.142/.146	2	-137	.240	.250	.120	.440	.062/.125	.250	2
-120	.135	.200	.063	.252	.106/.142	.142/.146	2	-138	.240	.312	.120	.440	.125/.187	.250	2
-121	.135	.240	.063	.252	.146/.118	.142/.146	2	-139	.240	.375	.120	.440	.187/.250	.250	2
-122	.135	.280	.063	.252	.177/.217	.142/.146	2	-140	.240	.500	.120	.440	.250/.375	.250	2
-123	.135	.310	.063	.252	.217/.256	.142/.146	2								

PANEL FASTENERS and HOLE PLUGS (continued)

**POLY DRIVE RIVETS**

Available in the following materials:

Material Code No.	Material Name
-18	Nylon 6/6, (natural)
-78	Nylon 6/6, (black)

Used in a wide variety of materials including plastic sheets, sheet metal, fiberglass, P.C. boards and composites, these molded nylon poly drive rivets provide a secure joint even under extreme vibration conditions.  
Fastener electrically insulates and resists corrosion and cathodic transfer.

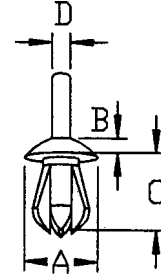

Part No. PN103 - (Size Code No.) - (Material Code No.)

Size Code No.	Panel Nom. Hole	Panel Thickness Range	Head	Head Dia. A	Head Hgt. B	Lock Lgth. C	Pin Dia. D	Size Code No.	Panel Nom. Hole	Panel Thickness Range	Head	Head Dia. A	Head Hgt. B	Lock Lgth. C	Pin Dia. D
-1	.218	.093/.350	ROUND	.375	.080	.450	.120	-280	.245	.140/.550	BINDER	.375	.100	.625	.150
-2	.156	.187/.250	BINDER	.218	.050	.312	.093	-285	.250	.125/.437	BINDER	.468	.080	.565	.150
-3	.218	.094/.312	BINDER	.437	.100	.464	.125	-29	.218	.031/.062	BUTTON	.375	.223	.170	.125
-4	.156	.218/.312	BINDER	.218	.050	.359	.093	-290	.250	.078/.275	BUTTON	.494	.305	.375	.155
-5	.187	.062/.187	TRUSS	.281	.050	.296	.125	-30	.182	.130/.290	TRUSS	.280	.050	.380	.120
-500	.226	.125/.312	TRUSS	.376	.0850	.467	.120	-301	.160	.062/.180	ROUND	.295	.050	.230	.093
-6	.156	.218/.383	BINDER	.218	.050	.421	.093	-32	.187	.156/.281	TRUSS	.437	.075	.380	.125
-7	.187	.156/.281	TRUSS	.430	.075	.380	.125	-33	.187	.062/.187	TRUSS	.437	.075	.295	.125
-8	.187	.062/.125	BINDER	.430	.120	.218	.125	-34	.226	.125/.312	TRUSS	.437	.075	.468	.125
-9	.187	.125/.187	TRUSS	.430	.075	.281	.125	-340	.250	.062/.125	ROUND	.370	.080	.218	.125
-90	.187	.062/.187	TRUSS	.430	.075	.285	.125	-35	.250	.093/.312	TRUSS	.468	.080	.500	.150
-10	.187	.031/.200	ROUND	.275	.075	.295	.125	-36	.250	.281/.500	TRUSS	.468	.080	.620	.150
-12	.187	.312/.440	BINDER	.281	.075	.535	.125	-360	.250	.109/.156	ROUND	.500	.312	.375	.155
-13	.187	.062/.187	ROUND	.281	.075	.295	.125	-37	.125	.031/.140	ROUND	.187	.047	.190	.075
-14	.187	.062/.125	ROUND	.281	.075	.230	.125	-38	.125	.031/.140	ROUND	.218	.060	.225	.075
-15	.187	.078/.375	ROUND	.281	.047	.450	.125	-39	.218	.187/.250	TRUSS	.375	.080	.343	.120
-16	.187	.312/.440	ROUND	.320	.109	.535	.125	-40	.275	.093/.350	BINDER	.620	.109	.480	.150
-17	.187	.375/.500	BINDER	.281	.080	.625	.125	-401	.280	.062/.350	TRUSS	.485	.075	.468	.187
-18	.187	.078/.375	ROUND	.320	.109	.455	.125	-41	.250	.093/.312	BINDER	.625	.109	.500	.150
-19	.275	.062/.600	ROUND	.370	.080	.640	.150	-42	.250	.281/.500	BINDER	.615	.109	.620	.150
-20	.187	.375/.500	ROUND	.320	.109	.609	.125	-420	.266	.093/.187	BINDER	.620	.109	.300	.150
-21	.187	.375/.750	ROUND	.320	.109	.850	.125	-423	.290	.093/.187	BINDER	.620	.109	.300	.150
-22	.250	.350/.500	BINDER	.468	.080	.620	.150	-425	.160	.218/.312	ROUND	.375	.050	.355	.093
-23	.250	.350/.500	ROUND	.370	.080	.620	.150	-43	.226	.125/.312	ROUND	.375	.080	.468	.120
-24	.250	.156/.330	BINDER	.468	.080	.375	.155	-44	.187	.062/.187	ROUND	.375	.080	.295	.125
-25	.250	.093/.312	BINDER	.468	.080	.500	.150	-45	.187	.156/.281	ROUND	.375	.080	.380	.125
-26	.187	.312/.440	BINDER	.312	.062	.535	.125	-46	.187	.062/.187	ROUND	.375	.080	.281	.125
-27	.187	.375/.500	BINDER	.315	.062	.609	.125	-460	.215	.078/.300	TRUSS	.630	.080	.430	.120
-28	.187	.078/.375	BINDER	.312	.062	.450	.125								

**MOLDED RIVETS**

STANDARD MATERIAL: -62 Acetal

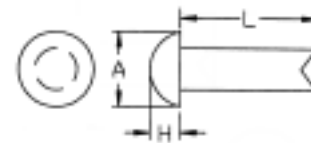

Part No. P106 - (Size Code No.) -62

Size Code No.	Shank Diam.	Head Dia. A	Head Hgt. H	Lgth. L	Size Code No.	Shank Diam.	Head Dia. A	Head Hgt. H	Lgth. L	Size Code No.	Shank Diam.	Head Dia. A	Head Hgt. H	Lgth. L	Size Code No.	Shank Diam.	Head Dia. A	Head Hgt. H	Lgth. L
-1	.085	.143	.058	1/8	-8	.125	.250	.068	1/8	-15	.125	.250	.068	9/16	-22	.125	.218	.090	3/8
-2	.085	.143	.058	3/16	-9	.125	.250	.068	3/16	-16	.125	.250	.068	5/8	-23	.125	.218	.090	1/2
-3	.085	.143	.058	1/4	-10	.125	.250	.068	1/4	-17	.125	.250	.068	11/16	-24	.125	.255	.051	1/4
-4	.085	.143	.058	5/16	-11	.125	.250	.068	5/16	-18	.125	.218	.090	1/8	-25	.125	.255	.051	3/8
-5	.085	.143	.058	3/8	-12	.125	.250	.068	3/8	-19	.125	.218	.090	3/16					
-6	.085	.143	.058	7/16	-13	.125	.250	.068	7/16	-20	.125	.218	.090	1/4					
-7	.085	.143	.058	1/2	-14	.125	.250	.068	1/2	-21	.125	.218	.090	5/16					

## POLY DRIVE RIVET SUPPORTS

Available in the following materials:

Material Code No.	Material Name
-18	Nylon 6/6, (natural)
-78	Nylon 6/6, (black)

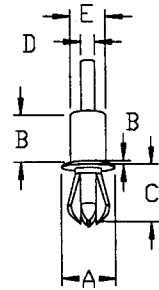

Part No. P104 - (Size Code No.) - (Material Code No.)

Size Code No.	Nomlnal Hole Diam.	Panel Thkness Range	Head Style	Head Diam. "A"	Head Hgt. "B"	Lock Length "C"	Pin Diam. "D"	Support Length "F"	Support Diam. "E"
-1	.187	.030/.125	Support	.325	.030	.200	.097	.400	.180
-2	.250	.030/.125	Support	.406	.047	.187	.125	.703	.240

## POLY DRIVE RIVET MOUNTING FEET

Available in the following materials:

Material Code No.	Material Name
-18	Nylon 6/6, (natural)
-78	Nylon 6/6, (black)

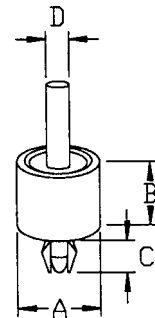

Part No. PA104 - (Size Code No.) - (Material Code No.)

Size Code No.	Nomlnal Hole Diam.	Panel Thkness Range	Head Style	Head Diam. "A"	Head Hgt. "B"	Lock Length "C"	Pin Diam. "D"
-1	.280	.061/.187	Foot	.760	.570	.385	.187
-2	.250	.030/.125	Foot	.375	.500	.238	.150

PANEL FASTENERS and HOLE PLUGS (continued)

## TWO PIECE ANCHOR RIVETS

\*Available in the following materials:

Material Code No.	Material Name
-18	Nylon 6/6, (natural)
-78	Nylon 6/6, (black)

*These 2 piece anchor rivets provide vibration-resistant blind fasteners for solid or hollow materials including wood, concrete, plaster, metal, plastic tile block or mortar. Rivet is inserted in predrilled hole and tapped with a hammer. The drive pin expands and seats the rivet securely in place.*

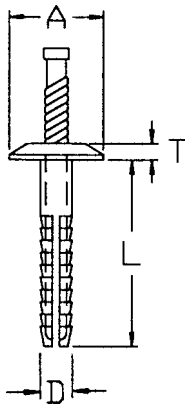

**MUSHROOM**

Type	A	B
Mushroom	.540	.110
Round	.425	.125
Truss	.605	.110
Flat	.437	.108

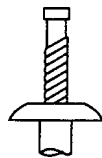

**TRUSS**



**ROUND**



**FLAT**

### TWO PIECE ANCHOR RIVET WITH STEEL DRIVE PIN

Part No. P112 - (Size Code No.) - (Material Code No.)

Size Code No.	"D"	"L"	Type
-1	3/16	3/4	Mushroom
-2	3/16	1	Mushroom
-3	1/4	3/4	Mushroom
-4	1/4	1	Mushroom
-5	1/4	1 1/2	Mushroom
-6	3/16	3/4	Round
-7	3/16	1	Round
-8	1/4	3/4	Round
-9	1/4	1	Round
-10	1/4	1 1/2	Round
-11	3/16	3/4	Truss
-12	3/16	1	Truss
-13	1/4	3/4	Truss
-14	1/4	1	Truss
-15	1/4	1 1/2	Truss

### TWO PIECE ANCHOR RIVET WITH NYLON DRIVE PIN

Part No. PN113 - (Size Code No.) - (Material Code No.)

Size Code No.	"D"	"L"	Type
-1	3/16	3/4	Mushroom
-2	1/4	3/4	Mushroom
-3	1/4	1	Mushroom
-4	1/4	1 1/2	Mushroom
-5	3/16	3/4	Round
-6	1/4	3/4	Round
-7	1/4	1	Round
-8	1/4	1 1/2	Round
-9	3/16	3/4	Truss
-10	1/4	3/4	Truss
-11	1/4	1	Truss
-12	1/4	1 1/2	Truss
-13	1/4	9/16	Flat
-14	1/4	3/4	Flat

**PANEL FASTENERS and HOLE PLUGS (continued)**

\*Available in the following materials:

Material Code No.	Material Name
-18	Nylon 6/6, (natural)
-78	Nylon 6/6, (black)

**TWO-PIECE REMOVABLE RIVETS**

Part No. P200 - (Size Code No.) - (Material Code No.)

Size Code No.	A	B	C	Hole Size	Panel Thickness
-1	3/8	.070	1/2	.188	1/16
-2	3/8	.070	1/2	.188	1/8
-3	7/16	.070	1/2	.250	1/16
-4	7/16	.070	1/2	.250	1/8
-5	7/16	.070	1/2	.250	3/16

These two-piece rivets can be removed by retracting the pin, and then the body.

The body incorporates a slot in line with the pin so that the pin can be removed.

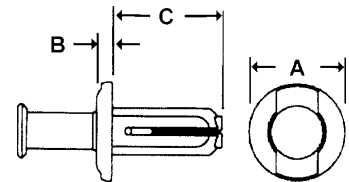

Tolerance for C dimension is +/- 1/32".

**RATCHETING ACTION RIVETS**

Ratcheting action rivets feature a rigid design which provides an outstanding bond created by the action of the interlocking gripper teeth. Large head diameter makes binding of soft materials a simple application.

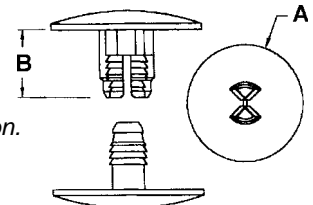

Part No. P210 - (Size Code No.) - (Material Code No.)

Size Code No.	Head Diam. A	Shank Length B	Hole Dia.	Grip Range	Size Code No.	Head Diam. A	Shank Length B	Hole Dia.	Grip Range
-1	3/4	7/32	9-32	.235/.297	-9	3/8	7/32	1/4	.235/.297
-2	3/4	11/32	9/32	.346/.500	-10	3/8	11/32	1/4	.346/.500
-3	3/4	1/2	9/32	.500/.812	-11	3/8	1/2	1/4	.500/.812
-4	3/4	3/4	9/32	.780/1.375	-12	3/8	3/4	1/4	.780/1.375
-5	.406	7/32	9/32	.235/.297	-13	5/8	7/32	1/4	.235/.297
-6	.406	11/32	9/32	.346/.500	-14	5/8	11/32	1/4	.346/.500
-7	.406	1/2	9/32	.500/.812	-15	5/8	1/2	1/4	.500/.812
-8	.406	3/4	9/32	.780/1.375	-16	5/8	3/4	1/4	.780/1.375

**RACHET FASTENERS**

These ratchet fasteners provide a fastening method over a wide range of panel thicknesses and materials. Easy hand installation assures quick assembly and strong and reliable finished product.

Available in the following materials:

Material Code No.	Material Name
-78	Nylon 6/6, (black)

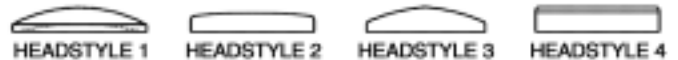

Part No. P220 - (Size code No.) - Material Code No.)

Size Code No.	Hole Size	Panel Thk. Range	Head-style	Head Size B	Head Height A	Lock Length C	Lock Figure
-100	.187	.030/.512	2	.437	.070	.680	1
-1	.187	.025/.365	1	.375	.070	.500	1
-2	.187	.030/.330	2	.435	.068	.562	2
-20	.187	.125/.365	4	.437	.070	.640	3
-24	.250	.020/.218	1	.720	.098	.425	1
-3	.250	.105/.300	1	.700	.100	.437	1
-4	.250	.150/.535	1	.700	.107	.783	2
-40	.250	.150/.535	1	.495	.074	.783	1
-42	.250	.062/.480	2	.492	.070	.787	1
-5	.281	.093/.500	1	.625	.110	.890	2

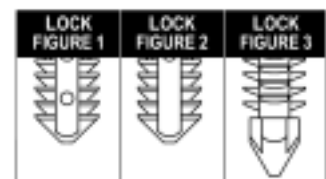
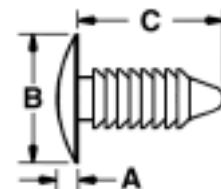

## "SPECIAL ITEM" TWO PIECE SCREW RIVETS

\*Available in the following materials:

Material Code No.	Material Name
-18	Nylon 6/6, (natural)
-78	Nylon 6/6, (black)

*These two piece screw rivets are designed to fasten larger components or small assemblies to their mating panels. Pressing or tapping the screw through the body creates a secure insulated connection. Screw may be removed with a phillips screw driver for fastener re-use.*

**Part No. PN173 - 1 - (Material Code No.)**

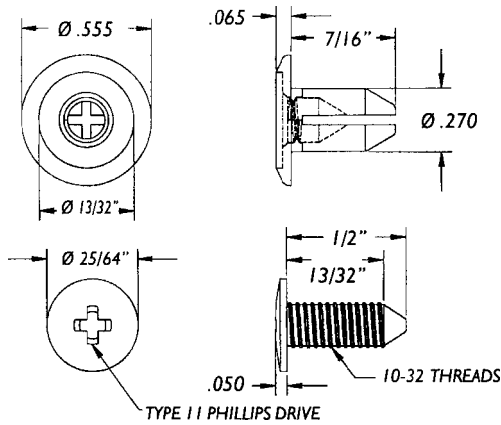

**Part No. PN175 - 2 - (Material Code No.)**

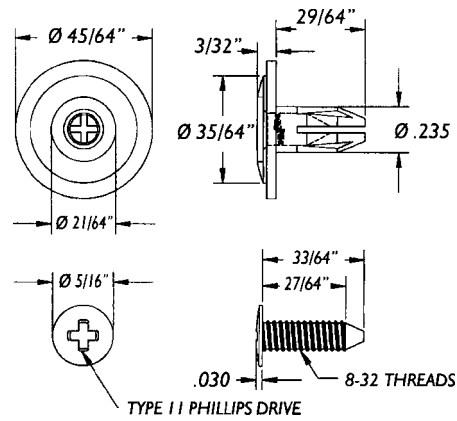

**Part No. PN174 - 3 - (Material Code No.)**

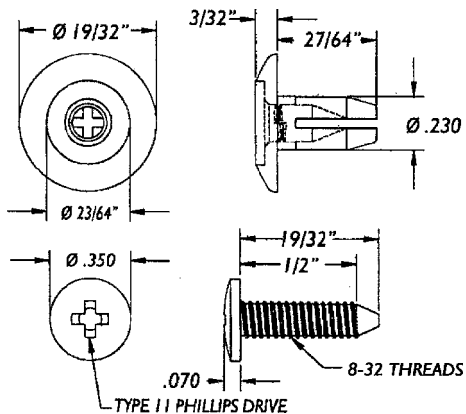

## SQUARE HEAD GROMMET NUTS

Available in the following materials:

Material Code No.	Material Name
-18	Nylon 6/6, (natural)
-78	Nylon 6/6, (black)

*Grommet nuts shown on pages 255-258 provide a positive connection for thin gauge materials while they eliminate the chance of cross-threading. The poly grommet snaps into a pre-punched square hole. The metal screw is encapsulated by the grommet, insulating it from electrical wiring and tubing while it guards against thermal and moisture transfer.*

Part No. PN109 - (Size Code No.) - (Material Code No.)

Size Code No.	Hole Size	Panel Thkness Range	Screw Size	Head Size B	Head Hgt. A	Lock Lgth. C
-1	.275/.290	.031/.125	8-10	.375	.031	.320
-2	.275/.290	.031/.125	8-10	.375	.062	.320
-3	.275/.290	.031/.125	8-10	.375	.125	.320
-4	.275/.290	.031/.125	8-10	.375	.250	.320
-40	.375	.031/.125	1/4	.625	1.062	.281
-5	.250/.260	.031/.115	6	.435	.094	.220
-6	.270/.270	.062/.275	6	.375/.500	.031	.435
-7	.225/.255	.031/.125	8	.375	.187	.300
-700	.250	.031/.160	8-10	.406	.030	.281
-70	.245/.255	.031/.125	6-8	.375	.032	.281
-8	.250/.255	.110/.125	6	.375	.031	.265
-80	.173/.178	.031/.078	4	.218	.250	.218
-9	.250/.270	.062/.155	6	.375	.032	.312
-90	.285	.078/.175	8	.380	.045	.340
-10	.275/.280	.040/.045	8-10	.370	.032	.330
-11	.350/.355	.218/.230	8-10	.475	.062	.421
-12	.370/.390	.064/.187	10	.609	.085	.290
-120	.305/.315	.031/.175	8	.470	.060	.300
-13	.370/.375	.031/.100	12	.620	.080	.275
-14	.173/.178	.031/.078	4	.218	.050	.218
-16	.270/.310	.031/.170	8	.405	.062	.312
-17	.310/.310	.031/.170	10	.465	.062	.295
-18	.320/.320	.031/.155	10	.650	.072	.305
-19	.245/.270	.047/.095	2	.375	.032	.240
-20	.335/.340	.062/.125	8	.512	.075	.315
-21	.270/.270	.062/.125	6	.390	.050	.275
-210	.270/.275	.031/.119	6	.375	.305	.281
-22	.275/.285	.031/.125	4	.375	.050	.218
-23	.200/.270	.032/.156	6	.312/.437	.035	.312
-24	.275/.280	.062/.120	6	.390	.055	.281
-240	.260/.270	.093/.187	6	.410	.040	.310
-245	.275	.047/.180	8	.375	.032	.327
-246	.370/.445	.062/.120	1/4	.625	.080	.281
-25	.370/.375	.062/.120	1/4	.625	.080	.281
-255	.320/.335	.032/.234	10	.470	.055	.420
-26	.335/.345	.062/.171	10	.468	.095	.400
-260	.330/.365	.032/.095	8	.500	.094	.295
-261	.250/.260	.062/.125	6	.375	.140	.265

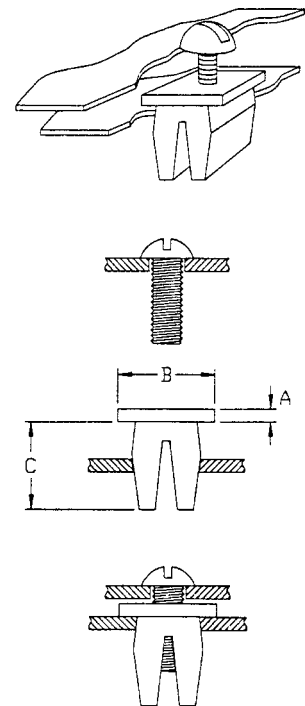

PANEL FASTENERS and HOLE PLUGS (continued)

Grommet nuts shown on pages 255-258 provide a positive connection for thin gauge materials while they eliminate the chance of cross-threading. The poly grommet snaps into a pre-punched square hole. The metal screw is encapsulated by the grommet, insulating it from electrical wiring and tubing while it guards against thermal and moisture transfer.

## ROUND HEAD GROMMET NUTS

Available in the following materials:

Material Code No.	Material Name
-18	Nylon 6/6, (natural)
-78	Nylon 6/6, (black)

Part No. PN111 - (Size Code No.) - (Material Code No.)

Size Code No.	Hole Size	Panel Thkness Range	Screw Size	Head Size B	Head Hgt. A	Lock Lgth. C
-100	.270/.280	.062/.165	6	.375	.093	.300
-102	.267/.272	.031/.109	8-10	.562	.562	.281
-1	.275/.290	.031/.125	8-10	.500	.031	.320
-2	.271/.290	.031/.125	8-10	.500	.062	.320
-3	.271/.290	.031/.125	8-10	.500	.125	.320
-4	.275/.290	.031/.125	8-10	.500	.250	.320
-5	.275/.290	.031/.156	8	.500	.375	.320
-6	.275/.290	.031/.156	8-10	.500	.708	.315
-7	.275/.290	.031/.156	8-10	.437	.032	.325
-8	.275/.290	.031/.109	8-10	.547	1.062	.281
-80	.281/.286	.031/.109	8-10	.492	.693	.281
-10	.425/.429	.031/.110	5/16	.740	.190	.312
-11	.310/.310	.031/.160	10	.500	.035	.292
-12	.325/.330	.031/.156	10	.565	.062	.320
-13	.350/.355	.032/.125	12	.531	.125	.281
-130	.350/.355	.032/.125	10	.562	.250	.320
-14	.415/.430	.032/.135	1/4	.750	.062	.310
-15	.275	.062/.170	8	.495	.312	.325
-16	.270/.280	.062/.165	6	.375	.093	.297
-17	.280/.285	.032/.150	6	1/2	23/32	11/32

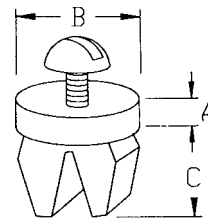

## CLOSED ROUND GROMMET NUTS

Available in the following materials:

Material Code No.	Material Name
-18	Nylon 6/6, (natural)
-78	Nylon 6/6, (black)

Part No. P149 - (Size Code No.) - (Material Code No.)

Size Code No.	Hole Size	Panel Thkness Range	Screw Size	Head Size B	Head Hgt. A	Lock Lgth. C
-2	.355/.355	.062/.350	10	.700	.050	.685

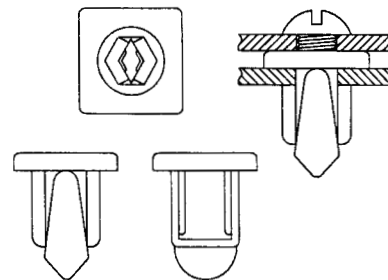

Grommet nuts shown on pages 255-258 provide a positive connection for thin gauge materials while they eliminate the chance of cross-threading. The poly grommet snaps into a pre-punched square hole. The metal screw is encapsulated by the grommet, insulating it from electrical wiring and tubing while it guards against thermal and moisture transfer.

## DOUBLE SPLIT SQUARE HEAD GROMMET NUTS

Available in the following materials:

Material Code No.	Material Name
-18	Nylon 6/6, (natural)
-78	Nylon 6/6, (black)

Part No. PN110 - (Size Code No.) - (Material Code No.)

Size Code No.	Hole Size	Panel Thkness Range	Screw Size	Head Size B	Head Hgt. A	Lock Lgth. C
-1	.377/.382	.125/.130	10	.609	.082	.308
-2	.228/.233	.250/.271	8	.375	.031	.406
-3	.310/.315	.110/.115	8	.437	.078	.281
-4	.305/.310	.125/.135	8	.437	.062	.281
-40	.375/.390	.230	1/4	.625	.080	.438
-5	.250/.250	.093/.275	8	.375	.047	.420
-6	.330/.330	.031/.125	8	.505	.032	.275
-7	.303	.031/.145	8-10	.435	.062	.270
-8	.410/.410	.031/.062	1/4	.630	.140	.280

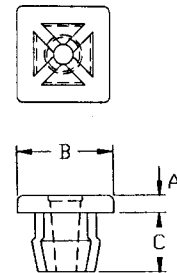

## THREE LEGGED SQUARE HEAD GROMMET NUTS

Available in the following materials:

Material Code No.	Material Name
-18	Nylon 6/6, (natural)
-78	Nylon 6/6, (black)

Part No. P148 - (Size Code No.) - (Material Code No.)

Size Code No.	Hole Size	Panel Thkness Range	Screw Size	Head Size B	Head Hgt. A	Lock Lgth. C
-1	.300/.300	.031/.135	6	.485	.055	.265

