

MOLDED NYLON THUMB SCREWS

*Available in the following materials:

Material Code No.	Material Name
-18	Nylon 6/6, (natural)
-78	Nylon 6/6, (black)

*Available in other materials. See material list in index.
Other sizes available on request.

SLOTTED THUMB SCREW

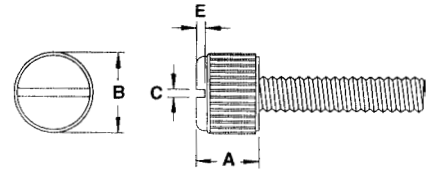

Part No. QN101 - (Size Code No.) - (Material Code No.)

Size Code No.	Thread Size	Length	Size Code No.	Thread Size	Length	Size Code No.	Thread Size	Length	Size Code No.	Thread Size	Length	Size Code No.	Thread Size	Length
-22	4-40	3/32	-49	6-32	3/32	-706	6-40	3/8	-95	10-24	3/16	-117	10-32	1 1/4
-23	4-40	1/8	-50	6-32	1/8	-73	6-40	3/4	-96	10-24	1/4	-118	10-32	1 1/2
-24	4-40	9/64	-51	6-32	5/32	-74	6-40	1	-97	10-24	5/16	-119	10-32	1 3/4
-26	4-40	3/16	-52	6-32	3/16	-75	8-32	1/8	-98	10-24	3/8	-120	10-32	2
-27	4-40	1/4	-53	6-32	1/4	-76	8-32	3/16	-99	10-24	1/2	-122	1/4-20	1/4
-28	4-40	9/32	-54	6-32	5/16	-77	8-32	1/4	-100	10-24	5/8	-123	1/4-20	5/16
-29	4-40	5/16	-55	6-32	3/8	-78	8-32	9/32	-101	10-24	3/4	-124	1/4-20	3/8
-30	4-40	3/8	-56	6-32	7/16	-79	8-32	5/16	-102	10-24	1	-126	1/4-20	1/2
-31	4-40	7/16	-57	6-32	1/2	-80	8-32	3/8	-103	10-24	1 1/4	-127	1/4-20	5/8
-32	4-40	1/2	-58	6-32	9/16	-81	8-32	7/16	-104	10-24	1 1/2	-128	1/4-20	3/4
-33	4-40	9/16	-59	6-32	5/8	-82	8-32	1/2	-106	10-32	1/8	-129	1/4-20	7/8
-34	4-40	5/8	-60	6-32	11/16	-83	8-32	5/8	-107	10-32	3/16	-130	1/4-20	1
-340	4-40	11/16	-61	6-32	3/4	-84	8-32	3/4	-108	10-32	1/4	-131	1/4-20	1 1/4
-341	4-40	3/4	-62	6-32	7/8	-85	8-32	7/8	-109	10-32	5/16	-132	1/4-20	1 1/2
-37	4-40	7/8	-64	6-32	1	-86	8-32	1	-110	10-32	3/8	-133	1/4-20	1 3/4
-38	4-40	1	-65	6-32	1 1/8	-87	8-32	1 1/8	-111	10-32	7/16	-134	1/4-20	2
-40	4-40	1 1/8	-66	6-32	1 1/4	-88	8-32	1 1/4	-112	10-32	1/2	-1340	1/4-20	2 1/2
-41	4-40	1 3/16	-67	6-32	1 1/2	-89	8-32	1 3/8	-113	10-32	5/8	-135	1/4-28	3/16
-42	4-40	1 1/4	-68	6-32	1 5/8	-90	8-32	1 1/2	-114	10-32	3/4	-1350	1/4-28	1/4
-43	4-40	1 3/8	-69	6-32	1 3/4	-91	8-32	1 3/4	-115	10-32	7/8	-136	1/4-28	3/8
-44	4-40	1 1/2	-70	6-32	1 7/8	-92	8-32	1 7/8	-1150	10-32	13/16	-137	1/4-28	1/2
-45	4-40	1 3/4	-700	6-32	2 1/4	-93	8-32	2	-116	10-32	1	-139	1/4-28	3/4
-46	4-48	1/4	-705	6-40	1/4	-94	10-24	1/8	-1160	10-32	1 1/16	-140	1/4-28	1

Thread Size	B	A	C	E	Thread Size	B	A	C	E
4	.317	.216	.039	.045	10	.395	.305	.040	.060
6	.336	.243	.035	.051	1/4	.480	.305	.045	.060
8	.381	.280	.049	.040					

MOLDED NYLON THUMB SCREWS (continued)

*Available in the following materials:

Material Code No.	Material Name
-18	Nylon 6/6, (natural)
-78	Nylon 6/6, (black)

*Available in other materials. See material list in index.
Other sizes available on request.

KNURLED THUMB SCREW

Part No. JN100 - (Size Code No.) - (Material Code No.)

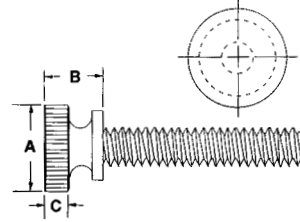

Size Code No.	Thread Size	Length	Size Code No.	Thread Size	Length	Size Code No.	Thread Size	Length	Size Code No.	Thread Size	Length	Size Code No.	Thread Size	Length
-100	4-40	3/16	-9	6-32	1	-18	10-24	1 1/4	-24	10-32	2	-33	5/16-18	2
-1	4-40	1/4	-10	8-32	3/16	-19	10-24	2	-25	1/4-20	1/2	-34	3/8-16	1/2
-2	4-40	3/8	-100	8-32	1/4	-20	10-32	3/8	-26	1/4-20	3/4	-35	3/8-16	1
-3	4-40	1/2	-11	8-32	3/8	-21	10-32	1/2	-27	1/4-20	1	-36	3/8-16	1 1/2
-4	4-40	3/4	-12	8-32	1/2	-210	10-32	5/8	-28	1/4-20	1 1/4	-37	3/8-16	2
-5	6-32	1/4	-13	8-32	3/4	-22	10-32	3/4	-29	1/4-20	1 1/2	-38	1/2-13	1/2
-6	6-32	3/8	-14	8-32	1	-23	10-32	1	-30	5/16-18	1/2	-39	1/2-13	1
-7	6-32	1/2	-15	10-24	1/2	-2300	10-32	1 1/16	-31	5/16-18	1	-40	1/2-13	1 1/2
-8	6-32	3/4	-16	10-24	3/4	-230	10-32	1 1/2	-32	5/16-18	1 1/2	-41	1/2-13	2
			-17	10-24	1									

Thread Size	A	B	C	Thread Size	A	B	C
4	.300	.280	.125	1/4	.540	.365	.155
6	.360	.275	.125	5/16	.615	.385	.171
8	.425	.305	.140	3/8	.687	.430	.187
10	.425	.325	.140	1/2	.750	.468	.203

Nominal Screw Size	0000 thru 00	0 thru 12	1/4 thru 3/4
Nominal Screw Length	Tolerance on Length		
Up to 1/2 in., incl.	-0.01	-0.02	-0.03
Over 1/2 to 1 in., incl.	-0.02	-0.03	-0.03
Over 1 to 2 in., incl.	---	-0.06	-0.06
Over 2 in.	---	-0.09	-0.09

OVAL HEAD THUMB SCREW

Part No. JN102 - (Size Code No.) - (Material Code No.)

Size Code No.	Thread Size	Length
-1	1/4-20	3/8
-2	1/4-20	1/2
-3	1/4-20	5/8
-4	1/4-20	1
-5	1/4-20	1 1/2
-6	1/4-20	1 3/4
-7	1/4-20	2
-8	1/4-20	2 1/2

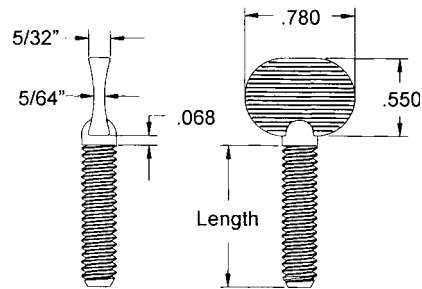

Nominal Screw Size	0000 thru 00	0 thru 12	1/4 thru 3/4
Nominal Screw Length	Tolerance on Length		
Up to 1/2 in., incl.	-0.01	-0.02	-0.03
Over 1/2 to 1 in., incl.	-0.02	-0.03	-0.03
Over 1 to 2 in., incl.	---	-0.06	-0.06
Over 2 in.	---	-0.09	-0.09

MOLDED NYLON CAP SCREWS

*Available in the following materials:

Material Code No.	Material Name
-18	Nylon 6/6, (natural)
-78	Nylon 6/6, (black)

*Available in other materials. See material list in index.
Other sizes available on request.

HEX HEAD CAP SCREW

Part No. IN201 - (Size Code No.) - (Material Code No.)

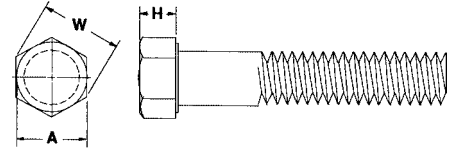

Size Code No.	Thread Size	Length	Size Code No.	Thread Size	Length	Size Code No.	Thread Size	Length	Size Code No.	Thread Size	Length
-3	1/4-20	3/8	-30	5/16-18	1 1/4	-50	3/8-16	3 1/2	-71	1/2-13	6
-5	1/4-20	1/2	-301	5/16-18	1 3/8	-51	3/8-16	4	-72	5/8-11	1/2
-6	1/4-20	5/8	-31	5/16-18	1 1/2	-52	3/8-16	4 1/2	-73	5/8-11	3/4
-7	1/4-20	3/4	-32	5/16-18	2	-53	3/8-16	5	-74	5/8-11	1
-9	1/4-20	1	-33	5/16-18	2 1/2	-54	3/8-16	5 1/2	-75	5/8-11	1 1/2
-10	1/4-20	1 1/4	-34	5/16-18	3	-55	3/8-16	6	-76	5/8-11	2
-11	1/4-20	1 1/2	-35	5/16-18	3 1/2	-550	3/8-24	1/2	-77	5/8-11	2 1/2
-111•	1/4-20	1 3/4	-36	5/16-18	4	-551	3/8-24	1 1/2	-78	5/8-11	3
-12	1/4-20	2	-37	5/16-18	4 1/2	-552	3/8-24	1 1/2	-79	5/8-11	3 1/2
-121	1/4-20	2 1/8	-38	5/16-18	5	-56	1/2-13	1/2	-80	5/8-11	4
-122	1/4-20	2 1/4	-39	5/16-18	5 1/2	-57	1/2-13	3/4	-800•	5/8-11	4
-13	1/4-20	2 1/2	-40	5/16-18	6	-58	1/2-13	7/8	-81	5/8-11	4 1/2
-131•	1/4-20	2 1/2	-41	5/16-24	1/2	-59	1/2-13	1	-82	5/8-11	5
-132	1/4-20	2 3/4	-410	5/16-24	1 1/2	-60	1/2-13	1 1/4	-83	5/8-11	5 1/2
-14	1/4-20	3	-412•	5/16-24	1 1/2	-61	1/2-13	1 1/2	-84	5/8-11	6
-15	1/4-20	3 1/2	-42	3/8-16	1/2	-610	1/2-13	1 3/4	-85	3/4-10	3/4
-16	1/4-20	4	-43	3/8-16	3/4	-63	1/2-13	2	-91•	3/4-10	4
-17	1/4-20	4 1/2	-44	3/8-16	1	-64	1/2-13	2 1/2	-94	3/4-10	5 1/2
-18	1/4-20	5	-45	3/8-16	1 1/4	-65	1/2-13	3	-96	7/8-9	3/4
-19	1/4-20	5 1/2	-46	3/8-16	1 1/2	-66	1/2-13	3 1/2	-97•	7/8-9	4 1/2
-20	1/4-20	6	-47	3/8-16	2	-67	1/2-13	4			
-27	5/16-18	1/2	-470•	3/8-16	2	-68	1/2-13	4 1/2			
-28	5/16-18	3/4	-48	3/8-16	2 1/2	-69	1/2-13	5			
-29	5/16-18	1	-49	3/8-16	3	-70	1/2-13	5 1/2			

• Full Threaded

Thread Size	A	W	H
1/4	.425-.438	.484-.505	.150-.188
5/16	.484-.500	.552-.577	.195-.235
3/8	.544-.562	.620-.650	.226-.268
1/2	.725-.750	.826-.866	.302-.364
5/8	.906-.938	1.033-1.083	.378-.444
3/4	1.088-1.125	1.240-1.299	.455-.524
7/8	1.269-1.312	1.447-1.516	.531-.604

Nominal Length	1/4-3/8	7/16-1/2	9/16-3/4	7/8-1	1 1/8-1 1/2	over 1 1/2
Up to 1 in., incl.	+0.02 -0.03	+0.02 -0.03	-0.02 -0.03	----- -----	----- -----	----- -----
Over 1 in. to 2 1/2 in., incl.	+0.02 -0.04	+0.04 -0.06	+0.06 -0.08	+0.08 -0.10	+0.12 -0.12	+0.18 -0.18
Over 2 1/2 to 4 in., incl.	+0.04 -0.06	+0.06 -0.08	-0.08 -0.10	+0.10 -0.14	+0.16 -0.16	+0.20 -0.20
Over 4 in. to 6 in., incl.	+0.06 -0.10	-0.08 -0.10	+0.10 -0.10	+0.12 -0.16	+0.18 -0.18	+0.22 -0.22
Longer than 6 in.	+0.10 -0.18	+0.12 -0.18	+0.14 -0.18	+0.16 -0.20	+0.22 -0.22	+0.24 -0.24

MOLDED NYLON CAP SCREWS (continued)

*Available in the following materials:

Material Code No.	Material Name
-18	Nylon 6/6, (natural)
-78	Nylon 6/6, (black)

*Available in other materials. See material list in index.
Other sizes available on request.

SLOTTED HEX WASHER CAP SCREW

Part No. IN202 - (Size Code No.) - (Material Code No.)

Size Code No.	Thread Size	Length
-1	3/8-16	1/2
-2	3/8-16	3/4
-3	3/8-16	1
-4	3/8-16	1 1/4
-5	3/8-16	1 1/2
-6	3/8-16	2
-7	3/8-16	2 1/2
-8	3/8-16	3

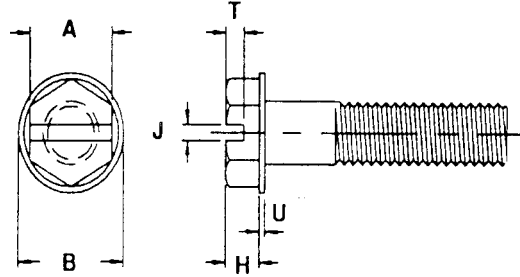

Thread Size	A	B	H	U	J	T
3/8	.558	.745	.282	.050	.087	.149

SLOTTED HEX HEAD CAP SCREW

Part No. IN200 - (Size Code No.) - (Material Code No.)

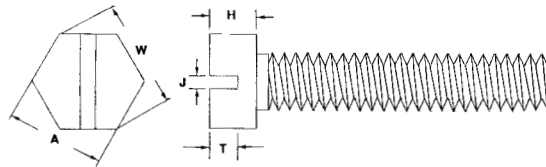

Size Code No.	Thread Size	Length	Size Code No.	Thread Size	Length	Size Code No.	Thread Size	Length	Size Code No.	Thread Size	Length
-3	1/4-20	3/8	-29	5/16-18	1	-46	3/8-16	1 1/2	-66	1/2-13	3 1/2
-5	1/4-20	1/2	-30	5/16-18	1 1/4	-47	3/8-16	2	-67	1/2-13	4
-6	1/4-20	5/8	-300	5/16-18	1 3/8	-48	3/8-16	2 1/2	-68	1/2-13	4 1/2
-7	1/4-20	3/4	-31	5/16-18	1 1/2	-49	3/8-16	3	-69	1/2-13	5
-9	1/4-20	1	-310	5/16-18	1 3/4	-50	3/8-16	3 1/2	-70	1/2-13	5 1/2
-10	1/4-20	1 1/4	-32	5/16-18	2	-51	3/8-16	4	-71	1/2-13	6
-11	1/4-20	1 1/2	-321*	5/16-18	2	-52	3/8-16	4 1/2	-72	5/8-11	1/2
-12	1/4-20	2	-33	5/16-18	2 1/2	-53	3/8-16	5	-73	5/8-11	3/4
-121	1/4-20	2 1/8	-34	5/16-18	3	-54	3/8-16	5 1/2	-74	5/8-11	1
-122	1/4-20	2 1/4	-35	5/16-18	3 1/2	-55	3/8-16	6	-75	5/8-11	1 1/2
-13	1/4-20	2 1/2	-36	5/16-18	4	-550	3/8-24	1/2	-76	5/8-11	2
-14	1/4-20	3	-37	5/16-18	4 1/2	-56	1/2-13	1/2	-77	5/8-11	2 1/2
-15	1/4-20	3 1/2	-38	5/16-18	5	-57	1/2-13	3/4	-78	5/8-11	3
-16	1/4-20	4	-39	5/16-18	5 1/2	-58	1/2-13	7/8	-79	5/8-11	3 1/2
-17	1/4-20	4 1/2	-40	5/16-18	6	-59	1/2-13	1	-80	5/8-11	4
-18	1/4-20	5	-41	5/16-24	1/2	-60	1/2-13	1 1/4	-800*	5/8-11	4
-19	1/4-20	5 1/2	-42	3/8-16	1/2	-61	1/2-13	1 1/2	-81	5/8-11	4 1/2
-20	1/4-20	6	-43	3/8-16	3/4	-63	1/2-13	2	-82	5/8-11	5
-27	5/16-18	1/2	-44	3/8-16	1	-64	1/2-13	2 1/2	-83	5/8-11	5 1/2
-28	5/16-18	3/4	-45	3/8-16	1 1/4	-65	1/2-13	3	-84	5/8-11	6

*Full Threaded

Thread Size	A	W	H	J	T
1/4	.425-.438	.484-.505	.150-.188	.070	.090
5/16	.484-.500	.552-.577	.195-.235	.080	.110
3/8	.544-.562	.620-.650	.226-.268	.090	.140
1/2	.725-.750	.826-.866	.302-.364	.075	.163
5/8	.906-.938	1.033-1.083	.378-.444	.110	.170

Nominal Length	1/4-3/8	7/16-1/2	9/16-3/4	7/8-1	1 1/8-1 1/2	over 1 1/2
Up to 1 in., incl.	+0.02 -0.03	+0.02 -0.03	-0.02 -0.03	----- -----	----- -----	----- -----
Over 1 in. to 2 1/2 in., incl.	+0.02 -0.04	+0.04 -0.06	+0.06 -0.08	+0.08 -0.10	+0.12 -0.12	+0.18 -0.18
Over 2 1/2 to 4 in., incl.	+0.04 -0.06	+0.06 -0.08	-0.08 -0.10	+0.10 -0.14	+0.16 -0.16	+0.20 -0.20
Over 4 in. to 6 in., incl.	+0.06 -0.10	-0.08 -0.10	+0.10 -0.10	+0.12 -0.16	+0.18 -0.18	+0.22 -0.22
Longer than 6 in.	+0.10 -0.18	+0.12 -0.18	+0.14 -0.18	+0.16 -0.20	+0.22 -0.22	+0.24 -0.24

MOLDED NYLON SET and GRUB SCREWS

*Available in the following materials:

Material Code No.	Material Name
-18	Nylon 6/6, (natural)
-78	Nylon 6/6, (black)

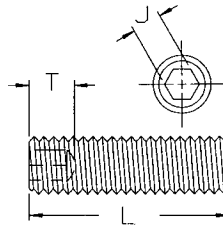

Nominal Screw Length	Tolerance on Length
Up to 0.63, incl.	+/-0.01
Over 0.63 to 2.00, incl.	+/-0.02
Over 2.00 to 6.00, incl.	+/-0.03
Over 6.00	+/-0.06

NYLON SOCKET SET SCREW

Part No. H101 - (Size Code No.) - (Material Code No.)

Size Code No.	Thrd. Size	Lgth.	Size Code No.	Thrd. Size	Lgth.	Size Code No.	Thrd. Size	Lgth.	Size Code No.	Thrd. Size	Lgth.	Size Code No.	Thrd. Size	Lgth.	Thread Size	J	T
-1000	4-36	1/2	-26	6-32	1/8	-51	8-32	3/16	-78	10-24	1 1/4	-103	1/4-20	1 1/4	4	.050	.070
-1	4-40	3/32	-27	6-32	5/32	-52	8-32	1/4	-79	10-24	1 1/2	-104	1/4-20	1 1/2	6	.062	.080
-2	4-40	1/8	-28	6-32	3/16	-53	8-32	9/32	-80	10-32	1/8	-105	1/4-20	1 3/4	8	.078	.090
-3	4-40	9/64	-29	6-32	1/4	-54	8-32	5/16	-81	10-32	3/16	-106	1/4-20	2	10	.094	.100
-4	4-40	5/32	-30	6-32	5/16	-55	8-32	3/8	-82	10-32	1/4	-1060	1/4-20	2 1/2	1/4	.125	.125
-5	4-40	3/16	-31	6-32	3/8	-56	8-32	7/16	-83	10-32	5/16	-107	1/4-28	3/16	5/16	.156	.156
-6	4-40	1/4	-32	6-32	7/16	-57	8-32	1/2	-84	10-32	3/8	-1070	1/4-28	1/4	3/8	.188	.188
-7	4-40	9/32	-33	6-32	1/2	-58	8-32	5/8	-85	10-32	7/16	-108	1/4-28	3/8	1/2	.250	.250
-8	4-40	5/16	-34	6-32	9/16	-59	8-32	3/4	-86	10-32	1/2	-1080	1/4-28	5/8	5/8	.312	.312
-9	4-40	3/8	-35	6-32	5/8	-60	8-32	7/8	-87	10-32	5/8	-109	1/4-28	3/4	3/4	.370	.185
-10	4-40	7/16	-36	6-32	11/16	-61	8-32	1	-88	10-32	3/4	-110	1/4-28	1			
-11	4-40	1/2	-37	6-32	3/4	-62	8-32	1 1/8	-880	10-32	13/16	-111	5/16-18	1/2			
-12	4-40	9/16	-38	6-32	7/8	-63	8-32	1 1/4	-89	10-32	7/8	-112	5/16-18	3/4			
-13	4-40	5/8	-39	6-32	1	-64	8-32	1 3/8	-90	10-32	1	-113	5/16-18	1			
-14	4-40	11/16	-40	6-32	1 1/8	-65	8-32	1 1/2	-900	10-32	1 1/16	-114	3/8-16	1/2			
-15	4-40	3/4	-41	6-32	1 1/4	-66	8-32	1 3/4	-91	10-32	1 1/4	-115	3/8-16	3/4			
-16	4-40	7/8	-42	6-32	1 1/2	-67	8-32	1 7/8	-92	10-32	1 1/2	-116	3/8-16	1			
-17	4-40	1	-43	6-32	1 5/8	-68	8-32	2	-93	10-32	1 3/4	-117	1/2-13	1/2			
-18	4-40	1 1/8	-44	6-32	1 3/4	-69	10-24	1/8	-94	10-32	2	-118	1/2-13	3/4			
-19	4-40	1 3/16	-45	6-32	1 7/8	-70	10-24	3/16	-95	1/4-20	1/4	-119	1/2-13	1			
-20	4-40	1 1/4	-450	6-32	2	-71	10-24	1/4	-96	1/4-20	5/16	-120	1/2-13	1 1/4			
-21	4-40	1 3/8	-451	6-32	2 1/4	-72	10-24	5/16	-97	1/4-20	3/8	-121	5/8-11	1/2			
-22	4-40	1 1/2	-46	6-40	1/4	-73	10-24	3/8	-98	1/4-20	1/2	-122	5/8-11	3/4			
-220	4-40	1 5/8	-47	6-40	3/8	-74	10-24	1/2	-99	1/4-20	5/8	-123	5/8-11	1			
-23	4-40	1 3/4	-48	6-40	3/4	-75	10-24	5/8	-100	1/4-20	3/4	-124	5/8-11	1 1/2			
-24	4-48	1/4	-49	6-40	1	-76	10-24	3/4	-101	1/4-20	7/8	-125	3/4-10	1/4			
-25	6-32	3/32	-50	8-32	1/8	-77	10-24	1	-102	1/4-20	1						

NYLON SLOTTED GRUB SCREW

Part No. H105 - (Size Code No.) - (Material Code No.)

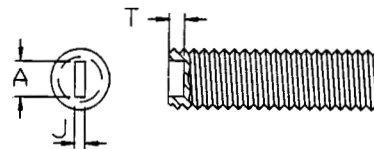

Thread Size	T	A	J
6	.030	.080	.025
8	.035	.080	.028
10	.050	.130	.035
1/4	.060	.160	.040
3/8	.100	.254	.064
1/2	.130	.350	.075
1	.178	.115	.516

Size Code No.	Thrd. Size	Lgth.	Size Code No.	Thrd. Size	Lgth.	Size Code No.	Thrd. Size	Lgth.	Size Code No.	Thrd. Size	Lgth.	Size Code No.	Thrd. Size	Lgth.	Size Code No.	Thrd. Size	Lgth.
-1	6-32	3/32	-18	6-32	1 1/2	-35	8-32	3/4	-52	10-24	3/4	-69	10-32	1 1/4	-86	1/4-28	3/16
-2	6-32	1/8	-19	6-32	1 5/8	-36	8-32	7/8	-53	10-24	1	-70	10-32	1 1/2	-87	1/4-28	1/4
-3	6-32	5/32	-20	6-32	1 3/4	-37	8-32	1	-54	10-24	1 1/4	-71	10-32	1 3/4	-88	1/4-28	3/8
-4	6-32	3/16	-21	6-32	1 7/8	-38	8-32	1 1/8	-55	10-24	1 1/2	-72	10-32	2	-89	1/4-28	5/8
-5	6-32	1/4	-22	6-40	1/4	-39	8-32	1 1/4	-56	10-32	1/8	-73	1/4-20	1/4	-90	1/4-28	3/4
-6	6-32	5/16	-23	6-40	3/8	-40	8-32	1 3/8	-57	10-32	3/16	-74	1/4-20	5/16	-91	1/4-28	1
-7	6-32	3/8	-24	6-40	3/4	-41	8-32	1 1/2	-58	10-32	1/4	-75	1/4-20	3/8	-92	3/8-16	1/2
-8	6-32	7/16	-25	6-40	1	-42	8-32	1 3/4	-59	10-32	5/16	-76	1/4-20	1/2	-93	3/8-16	3/4
-9	6-32	1/2	-26	8-32	1/8	-43	8-32	1 7/8	-60	10-32	3/8	-77	1/4-20	5/8	-94	3/8-16	1
-10	6-32	9/16	-27	8-32	3/16	-44	8-32	2	-61	10-32	7/16	-78	1/4-20	3/4	-95	1/2-13	1/2
-11	6-32	5/8	-28	8-32	1/4	-45	10-24	1/8	-62	10-32	1/2	-79	1/4-20	7/8	-96	1/2-13	3/4
-12	6-32	11/16	-29	8-32	9/32	-46	10-24	3/16	-63	10-32	5/8	-80	1/4-20	1	-97	1/2-13	1
-13	6-32	3/4	-30	8-32	5/16	-47	10-24	1/4	-64	10-32	3/4	-81	1/4-20	1 1/4	-98	1-8	5/8
-14	6-32	7/8	-31	8-32	3/8	-48	10-24	5/16	-65	10-32	13/16	-82	1/4-20	1 1/2			
-15	6-32	1	-32	8-32	7/16	-49	10-24	3/8	-66	10-32	7/8	-83	1/4-20	1 3/4			
-16	6-32	1 1/8	-33	8-32	1/2	-50	10-24	1/2	-67	10-32	1	-84	1/4-20	2			
-17	6-32	1 1/4	-34	8-32	5/8	-51	10-24	5/8	-68	10-32	1 1/16	-85	1/4-20	2 1/2			

MOLDED NYLON SET SCREWS (continued)

*Available in the following materials:

Material Code No.	Material Name
-18	Nylon 6/6, (natural)
-78	Nylon 6/6, (black)

*Available in other materials. See materials list in index.
Other sizes available on request.

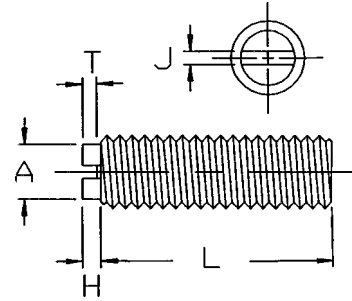

NYLON SLOTTED SET SCREW

Part No. H100 - (Size Code No.) - (Material Code No.)

Size Code No.	Thread Size	Length	Size Code No.	Thread Size	Length	Size Code No.	Thread Size	Length	Size Code No.	Thread Size	Length
-3	2-56	1/16	-45	4-40	1	-82	8-32	1/8	-119	10-32	5/8
-4	2-56	3/32	-47	4-40	1 1/8	-83	8-32	3/16	-120	10-32	3/4
-5	2-56	1/8	-48	4-40	1 3/16	-84	8-32	1/4	-1200	10-32	13/16
-6	2-56	5/32	-49	4-40	1 1/4	-85	8-32	9/32	-121	10-32	7/8
-7	2-56	3/16	-50	4-40	1 3/8	-86	8-32	5/16	-122	10-32	1
-8	2-56	1/4	-51	4-40	1 1/2	-87	8-32	3/8	-1220	10-32	1 1/16
-9	2-56	9/32	-510	4-40	1 5/8	-88	8-32	7/16	-123	10-32	1 1/4
-10	2-56	5/16	-52	4-40	1 3/4	-89	8-32	1/2	-124	10-32	1 1/2
-11	2-56	3/8	-53	4-48	1/4	-90	8-32	5/8	-125	10-32	1 3/4
-12	2-56	7/16	-56	6-32	3/32	-91	8-32	3/4	-126	10-32	2
-13	2-56	1/2	-57	6-32	1/8	-92	8-32	7/8	-128	1/4-20	1/4
-14	2-56	9/16	-58	6-32	5/32	-93	8-32	1	-129	1/4-20	5/16
-15	2-56	5/8	-59	6-32	3/16	-94	8-32	1 1/8	-130	1/4-20	3/8
-16	2-56	3/4	-60	6-32	1/4	-95	8-32	1 1/4	-132	1/4-20	1/2
-17	2-56	7/8	-61	6-32	5/16	-96	8-32	1 3/8	-133	1/4-20	5/8
-18	2-56	1	-62	6-32	3/8	-97	8-32	1 1/2	-134	1/4-20	3/4
-180	2-56	1 1/8	-63	6-32	7/16	-98	8-32	1 3/4	-135	1/4-20	7/8
-19	2-64	3/16	-64	6-32	1/2	-99	8-32	1 7/8	-136	1/4-20	1
-20	2-64	3/8	-65	6-32	9/16	-100	8-32	2	-137	1/4-20	1 1/4
-280	4-36	1/2	-66	6-32	5/8	-101	10-24	1/8	-138	1/4-20	1 1/2
-29	4-40	3/32	-67	6-32	11/16	-102	10-24	3/16	-139	1/4-20	1 3/4
-30	4-40	1/8	-68	6-32	3/4	-103	10-24	1/4	-140	1/4-20	2
-31	4-40	9/64	-69	6-32	7/8	-104	10-24	5/16	-1400	1/4-20	2 1/2
-32	4-40	5/32	-71	6-32	1	-105	10-24	3/8	-141	1/4-28	3/16
-33	4-40	3/16	-72	6-32	1 1/8	-106	10-24	1/2	-1410	1/4-28	1/4
-34	4-40	1/4	-73	6-32	1 1/4	-107	10-24	5/8	-142	1/4-28	3/8
-35	4-40	9/32	-74	6-32	1 1/2	-108	10-24	3/4	-144	1/4-28	5/8
-36	4-40	5/16	-75	6-32	1 5/8	-109	10-24	1	-145	1/4-28	3/4
-37	4-40	3/8	-76	6-32	1 3/4	-110	10-24	1 1/4	-146	1/4-28	1
-38	4-40	7/16	-77	6-32	1 7/8	-111	10-24	1 1/2	-1560	5/16-24	13/16
-39	4-40	1/2	-770	6-32	2	-113	10-32	1/8	-164*	3/8-24	5/16
-40	4-40	9/16	-771	6-32	2 1/4	-114	10-32	3/16			
-41	4-40	5/8	-78	6-40	1/4	-115	10-32	1/4			
-42	4-40	11/16	-79	6-40	3/8	-116	10-32	5/16			
-43	4-40	3/4	-80	6-40	3/4	-117	10-32	3/8			
-44	4-40	7/8	-81	6-40	1	-118	10-32	1/2			

*Slot is in threads.

Thread Size

Size	A	H	J	T
2	.055	.035	.018	.020
4	.075	.045	.020	.025
6	.100	.055	.025	.030
8	.120	.055	.028	.035
10	.150	.060	.035	.050
1/4	.175	.080	.040	.060
5/16	.246	.078	.051	.078

Nominal Screw Size	0000 thru 00	0 thru 12	1/4 thru 3/4
Nominal Screw Length	Tolerance on Length		
Up to 1/2 in., incl.	-0.01	-0.02	-0.03
Over 1/2 to 1 in., incl.	-0.02	-0.03	-0.03
Over 1 to 2 in., incl.	----	-0.06	-0.06
Over 2 in.	----	-0.09	-0.09