

HIGH TECHNOLOGY PLASTIC SHOULDER BUSHINGS

*Available in the following materials:

Material Code No.	Material Name	Material Code No.	Material Name	Material Code No.	Material Name
-3	Lexan®, (clear)	-24	Delrin®	-40	PFA, (Teflon®)
-4	Lexan®, (black)	-27	PVC	-41	Halar®
-5	Ultem® 1000	-28	CPVC	-60	Nylon 6/6, 30% Short Glass-filled
-9	Celcon®	-29	Teflon®	-77	Ultem® 2300, (natural)
-10	Celcon®, Glass-filled	-30	Tefzel®	-78	Nylon 6/6, (black)
-11	Polypropylene	-32	PCTFE	-213	VespeI®
-13	Polyethylene	-33	Polysulfone	-272	PVC, (white)
-14	ABS	-35	Noryl®	-273	PVC, (black)
-15	PEEK™	-37	PVDF		
-18	Nylon 6/6, (natural)	-38	Fiber Glass G10		
-23	Nylon Super Tough	-39	UHMW®		

*Available in other materials.
See materials list in index.
Other sizes available on request.

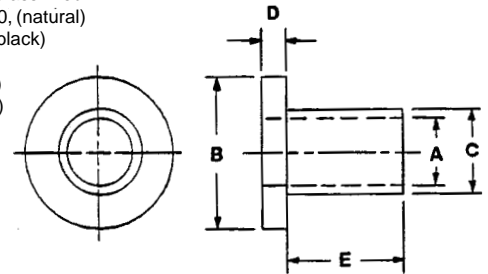

Part No. DN211 - (Size Code No.) - (Material Code No.)

Size Code No.	A Shank I.D.	B Flange O.D.	C Shank O.D.	D Flange Thk.	E Shank Thk.	Size Code No.	A Shank I.D.	B Flange O.D.	C Shank O.D.	D Flange Thk.	E Shank Thk.
-1	.089	.250	.158	.030	.135	-42	.174	.375	.218	.062	.187
-2	.093	.187	.125	.062	.125	-43	.174	.375	.218	.062	.250
-3	.093	.187	.125	.062	.187	-44	.174	.375	.218	.062	.312
-4	.093	.187	.125	.062	.250	-45	.174	.375	.218	.062	.375
-5	.093	.187	.125	.062	.312	-46	.174	.375	.218	.062	.437
-6	.093	.187	.125	.062	.375	-47	.174	.375	.218	.062	.500
-7	.105	.510	.305	.065	.080	-48	.180	.375	.305	.400	.160
-8	.120	.330	.220	.030	.285	-49	.180	.410	.250	.035	.140
-9	.120	.625	.250	.065	.250	-50	.180	.430	.305	.070	.215
-10	.125	.250	.156	.062	.125	-51	.180	.430	.305	.078	.250
-11	.125	.250	.156	.062	.187	-52	.185	.430	.310	.060	.250
-12	.125	.250	.156	.062	.250	-53	.185	.435	.250	.120	.130
-13	.125	.310	.180	.065	.335	-54	.185	.435	.310	.060	.230
-14	.125	.437	.250	.040	.103	-55	.185	.435	.316	.070	.230
-15	.125	.500	.240	.060	.030	-56	.185	.440	.305	.065	.255
-16	.130	.355	.150	.065	.080	-57	.185	.500	.310	.125	.155
-17	.130	.375	.320	.125	.125	-58	.187	.500	.322	.060	.310
-18	.135	.375	.250	.065	.085	-59	.190	.370	.250	.125	.080
-19	.135	.555	.215	.133	.102	-60	.190	.400	.280	.065	.630
-20	.140	.315	.233	.055	.045	-61	.190	.435	.250	.065	.095
-21	.140	.367	.232	.095	.085	-62	.190	.440	.315	.060	.255
-22	.140	.375	.185	.045	.045	-63	.190	.490	.370	.105	.270
-23	.140	.375	.235	.060	.030	-64	.190	.500	.250	.125	.165
-24	.140	.437	.279	.037	.077	-65	.190	.505	.255	.065	.170
-25	.140	.443	.260	.150	.105	-66	.190	1.000	.365	.060	.165
-26	.140	.490	.255	.060	.065	-67	.195	.440	.250	.125	.255
-27	.140	.490	.260	.060	.170	-68	.195	.620	.370	.070	.557
-28	.145	.290	.205	.035	.147	-69	.195	.750	.320	.065	.250
-29	.147	.312	.172	.062	.125	-70	.200	.437	.250	.062	.187
-30	.147	.312	.172	.062	.187	-71	.200	.437	.250	.062	.250
-31	.150	.230	.194	.015	.040	-72	.200	.437	.250	.062	.312
-32	.150	.390	.245	.080	.045	-73	.200	.437	.250	.062	.375
-33	.150	.580	.235	.062	.320	-74	.200	.437	.250	.062	.437
-34	.150	.590	.200	.062	.255	-75	.200	.437	.250	.062	.500
-35	.150	.730	.290	.125	.425	-76	.200	.440	.250	.063	.095
-36	.165	.250	.235	.022	.110	-77	.200	.440	.253	.065	.060
-37	.165	.340	.205	.065	.130	-78	.205	.425	.315	.070	.320
-38	.165	.340	.205	.065	.625	-79	.215	.435	.340	.310	.135
-39	.170	.350	.210	.065	.095	-80	.215	.555	.365	.105	.055
-40	.170	.750	.320	.065	.250						
-41	.170	.990	.365	.155	.190						

(continued next page)

Tolerances:
Flange O.D. +/- .005
Flange Thickness +/- .005

.089 I.D. to .215 I.D.

Shank O.D. - .005/+ .000
Shank Thickness +/- .005
Shank I.D. + .005/- .000

HIGH TECHNOLOGY PLASTIC SHOULDER BUSHINGS (continued)

*Available in the following materials:

Material Code No.	Material Name	Material Code No.	Material Name	Material Code No.	Material Name
-3	Lexan®, (clear)	-24	Delrin®	-40	PFA, (Teflon®)
-4	Lexan®, (black)	-27	PVC	-41	Halar®
-5	Ultem® 1000	-28	CPVC	-60	Nylon 6/6, 30% Short Glass-filled
-9	Celcon®	-29	Teflon®	-77	Ultem® 2300, (natural)
-10	Celcon®, Glass-filled	-30	Tefzel®	-78	Nylon 6/6, (black)
-11	Polypropylene	-32	PCTFE	-213	VespeI®
-13	Polyethylene	-33	Polysulfone	-272	PVC, (white)
-14	ABS	-35	Noryl®	-273	PVC, (black)
-15	PEEK™	-37	PVDF		
-18	Nylon 6/6, (natural)	-38	Fiber Glass G10		
-23	Nylon Super Tough	-39	UHMW®		

*Available in other materials.
See materials list in index.
Other sizes available on request.

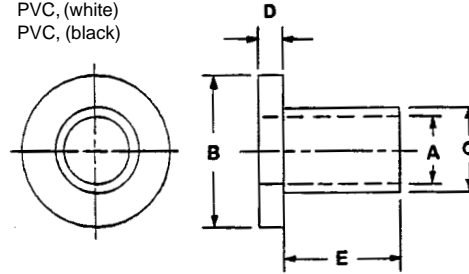

Part No. DN211 - (Size Code No.) - (Material Code No.)

Size Code No.	A Shank I.D.	B Flange O.D.	C Shank O.D.	D Flange Thk.	E Shank Thk.	Size Code No.	A Shank I.D.	B Flange O.D.	C Shank O.D.	D Flange Thk.	E Shank Thk.
-81	.220	.750	.320	.065	.250	-122	.316	.562	.374	.025	.156
-82	.228	.660	.356	.115	.282	-123	.316	.625	.373	.187	.396
-83	.235	.490	.370	.040	.035	-124	.316	.650	.375	.062	.270
-84	.240	.495	.400	.060	.085	-125	.335	.870	.617	.130	.490
-85	.240	.740	.350	.065	.250	-126	.356	.700	.566	.090	.700
-86	.240	.750	.495	.330	.160	-127	.365	1.238	.685	.310	.185
-87	.241	.408	.307	.031	.165	-128	.375	.555	.500	.060	.100
-88	.246	.406	.312	.031	.165	-129	.375	.755	.490	.130	1.010
-89	.250	.385	.310	.035	.720	-130	.375	.755	.493	.125	.030
-90	.250	.440	.310	.030	.130	-131	.375	.995	.490	.175	.050
-91	.250	.460	.350	.210	.740	-132	.385	.750	.500	.185	.065
-92	.250	.625	.378	.065	.315	-133	.388	.562	.438	.025	.265
-93	.251	.437	.281	.022	.086	-134	.400	.750	.500	.130	.090
-94	.252	.562	.380	.120	.260	-135	.406	.562	.500	.032	.250
-95	.254	.437	.310	.028	.156	-136	.415	.750	.560	.080	.550
-96	.254	.560	.372	.062	.500	-137	.420	.615	.500	.375	.315
-97	.254	.600	.372	.125	.250	-138	.430	.750	.500	.187	.036
-98	.255	.420	.315	.060	.180	-139	.500	.875	.620	.065	.190
-99	.255	.505	.365	.065	.370	-140	.505	.810	.690	.130	.370
-100	.255	.755	.320	.065	.250	-141	.515	.875	.625	.062	.620
-101	.256	.625	.344	.063	.328	-142	.750	1.000	.800	.030	.155
-102	.260	.430	.315	.063	.087	-143	.900	2.175	1.110	.125	1.000
-103	.260	.435	.340	.060	.025	-144	.930	1.500	1.010	.040	.265
-104	.260	.495	.370	.030	.045						
-105	.260	.500	.310	.065	.125						
-106	.260	.500	.312	.062	.187						
-107	.260	.500	.312	.062	.250						
-108	.260	.500	.312	.062	.312						
-109	.260	.500	.312	.062	.375						
-110	.260	.500	.312	.062	.437						
-111	.260	.500	.312	.062	.500						
-112	.260	.500	.315	.065	.075						
-113	.260	.750	.365	.130	.050						
-114	.305	.600	.382	.035	.125						
-115	.305	.615	.550	.063	.437						
-116	.308	.500	.375	.031	.156						
-117	.310	.500	.370	.035	.225						
-118	.310	.560	.455	.060	.085						
-119	.310	.870	.436	.090	.340						
-120	.312	.500	.380	.023	.146						
-121	.316	.468	.374	.025	.218						

Tolerances:
Flange O.D. +/- .005
Flange Thickness +/- .005

.220 I.D. to .930 I.D.

Shank O.D. - .005/+0.00
Shank Thickness +/- .005
Shank I.D. + .005/-0.00